

**SOUTHERN POWER DISTRIBUTION COMPANY OF A.P. LIMITED  
TIRUPATI**

**Memo.No.CGM/P&MM. & IPC/SPDCL/TPT/CIVIL/F.210/D.No. 1594 /17 dt. 13-06-2017**

Sub: SPDCL – Consolidated SPDCL SSR for the year 2016-17 – Issued – Reg.

Ref :- Note orders dated 13 -06-2017 of Chairman & Managing Director APSPDCL.

\*\*\*

With reference to the note orders dated 13-06-2017, the rates of SSR 2015-16 are revised and new SSR for the year 2016-17 is finalized. This SSR is effective from the date of issue.

Finalized copy of SSR-2016-17 is being sent through e-mail/e-office to all Chief Engineers/ Superintending Engineers/Divisional Engineers/Executive Engineers/Assistant Divisional Engineers/ Assistant Engineers/ Additional Assistant Engineers for implementation in the SPDCL from now onwards.

Encl: Copy of SPDCL  
SSR 2016-17.

**Sd/- K. SANTHOSHA RAO  
CHIEF GENERAL MANAGER  
P&MM & IPC  
APSPDCL :: TIRUPATI**

To

All Superintending Engineers/ Operation/SPDCL  
All Executive Engineer / Civil /APSPDCL, Tirupati.  
All Divisional Engineers/ Operation/ SPDCL  
All Divisional Engineers/ Transformers/ SPDCL  
All Divisional Engineer/ M&P/ SPDCL  
All Divisional Engineers/ Construction/SPDCL  
All Asst Div. Engineers/ Operation/ SPDCL  
All Assistant Engineers & Addl. Asst. Engineers/ Operation/ SPDCL

**Copy to**

The Chief Engineer/ Zone/ SPDCL/ Tirupati , Vijayawada & Kurnool.  
The Chief General Manager/ Planning/ SPDCL/ Tirupati.  
The Chief General Manager/ Projects/ SPDCL/ Tirupati.  
The Chief General Manager/ Opn./ SPDCL/ Tirupati.  
The Chief General Manager/Expenditure/SPDCL/ Tirupati.  
The Superintending Engineer / Civil/ Corporate Office/SPDDL/Tirupati  
The Superintending Engineer / Civil/ SPDDL/Vijayawada  
The Superintending Engineer / DPE/ SPDDL/Tirupati  
The Superintending Engineer / Assessments/ SPDCL/Tirupati.  
The Divisional Engineer/ DPE/ SPDCL  
The Divisional Engineer/ Assessments/ SPDCL  
Copy submitted to Peshi of Director/ Tech&HRD/ SPDCL/ Tirupati.  
Copy submitted to Peshi of Director/Finance/ SPDCL/ Tirupati.  
Copy submitted to Peshi of Chairman & Managing Director/ SPDCL/ Tirupati.

**FORWARDED BY ORDER**

  
**EXECUTIVE ENGINEER/CIVIL**

# SOUTHERN POWER DISTRIBUTION COMPANY OF ANDHRA PRADESH LIMITED



## COMMON STANDARD SCHEDULE OF RATES FOR THE YEAR 2016 - 2017

### INDEX

<b>Description</b>	<b>Page No.</b>
<b>I. Rates of Labour</b>	1-2
<b>II. Important note</b>	3
<b>III. Rates of Works</b>	4-23
<b>IV. Loading &amp; Unloading Charges</b>	24-27
<b>V. New items</b>	28
<b>VI. Transport Charges</b>	29-48

## **PREAMBLE**

A meeting was convened on 27-04-2017 headed by Sri P. Pulla Reddy, Director, Tech & HRD, APSPDCL, Tirupati with an objective to finalise and release the SSR for the year 2016-17.

The following Officers participated and discussed on revision of rates for preparation of SSR2016-17.

- 1 Sri K. Santhosha Rao, Chief General Manager, P&MM&IPC, APSPDCL, Tirupati
- 2 Sri. K. Nagaraju, Superintending Engineer, Civil, APSPDCL, Tirupati.
- 3 Sri. P. Bhaskar Reddy, Executive Engineer, Civil, APSPDCL, Tirupati
- 4 Smt. J. Ramadevi, Divisional Engineer, Tech, O/o SE/O/Nellore
- 5 Sri J. Sanjeeva Rao, Divisional Engineer, Tech, O/o SE/O/Vijayawada.
- 6 Sri M. Vasantha Rao, Divisional Engineer, Tech, O/o SE/O/Guntur.
- 7 Smt. N. Shobha Valentina Divisional Engineer, Tech, O/o SE/O/Kadapa
- 8 Sri. G. Chakrapani, Divisional Engineer, Tech, O/o SE/O/Tirupati
- 9 Sri. M.D.Sadiq, Divisional Engineer, Tech, O/o SE/O/Kurnool
- 10 Sri J. Sreenivasulu, Divisional Engineer, Tech, O/o SE/O/Anantapur
- 11 Sri. C. Raveendra Kumar, Divisional Engineer, Construction, Anantapur.
- 12 Sri E. Bala Rami Reddy, Assistant Divisional Engineer, Construction, Guntur
- 13 Sri J. Krishna Prasad, Assistant Divisional Engineer, Construction, Nellore.
- 14 Sri. R.Pradeep Kumar, Divisional Engineer, Construction, Kurnool.
- 15 Sri. S.Munisankaraiah, Divisional Engineer, Construction, Tirupati.
- 16 Sri.L. Narasimha Prasad, Divisional Engineer, Construction, Kadapa.
- 17 Sri K.Anji Reddy, Divisional Engineer, Construction, Ongole.
- 18 Sri. G. Vishnu vardhan, Assistant Divisional engineer, Civil, APSPDCL, Tirupati
- 19 Sri. P. Radha Krishna, Assistant Divisional Engineer, Civil, Anantapur.
- 20 Sri. M. Madhusudhana Rao, Assistant Divisional Engineer, Civil, Kadapa.
- 21 Sri M. Srinivasa rao, Assistant Divisional Engineer, Civil, Nellore.
- 22 Sri. G.Manohar, Assistant Divisional Engineer, Civil, Vijayawada.
- 23 Sri. B.Venugopal Reddy, Assistant Divisional engineer, Civil, APSPDCL, Ongole
- 24 Sri. D. Tirumala Rao, Assistant Divisional engineer, Civil, APSPDCL, Tirupati.
- 25 Sri. G. Ravi Kumar, Assistant Divisional Engineer, Civil, Guntur.
- 26 Sri. K.Sudhakar Babu, Assistant Divisional Engineer, Civil, Kurnool.

The SSR for the year 2016-17 is prepared based on the Govt. SSR 2016-17 vide Proc. No. ENC(B)/DEE-1/AEE-1SoR:2016-17 Dt:26.10.2016.

The SSR 2016-17 is effective from the date of issue.

## I. RATES OF LABOUR

Sl No.	Type of Labour	Unit	Rate
<b>1)</b>	<b>First Class:-</b>		
<b>a)</b>	Mason/ Brick Layer/ Welder/	Day	445.00
<b>b)</b>	Electrician(Licensed)	Day	515.00
<b>c)</b>	Fitter/ /Mechanic /Carpenter/	Day	475.00
<b>d)</b>	Painter/Plumber/Pipe fitter	Day	510.00
<b>2)</b>	<b>Second Class -</b> Mason/ Brick Layer/Carpenter/ Painter/Plumber/Welder/Fitter/Electrician/Mechanic	Day	400.00
<b>3)</b>	<b>Un-Skilled Work Men/Women</b>	Day	350.00
	AREA ALLOWANCES :-		
	<p><b>CORPORATIONS &amp; MUNICIPALITIES:</b></p> <p>a) (i) 25% extra over the rates on labour component of works is allowed in all Municipal Corporation Limits of Andhra Pradesh except Vijayawada municipal corporations (up to a belt of 12 Kms. from Municipal Corporation limits) and other corporations as notified by the Government from time to time.</p> <p>(ii) 40% extra over the rates on labour component of works for Vijayawada Municipal Corporation (up to a belt of 12 Kms. from Municipal Corporation limits).</p> <p>b) Allow 20% extra over basic rates on labour component of works in all District Headquarters and the remaining Municipal limits (up to a belt of 12 Kms from Municipal limits).</p> <p>c) For works at Tirumala Hills in Chittoor District, 40% extra over the basic rates of labour component is allowed.</p> <p>d) For works at Horsely hills in Chittoor District, 30% extra over the basic rates of labour component is allowed.</p>		
	<p><b>A. Jail Compounds:</b></p> <p>20% extra is allowed over labour rates for the work in the Jail compounds. Only equivalent number of Man Mazdoor shall be provided in the Jail premises and no women Mazdoor are allowed inside.</p>		
	<p><b>B. .INDUSTRIAL AREA:-</b></p> <p>Allow 20% extra over rates on labour component of works in the following Industrial Areas. (<i>within 10 Kms belt of Industrial area</i>)</p> <p>KRISHNA DIST.- Ibrahimpatnam Distribution, Vuyyuru Distribution, Jaggaiahpetta Distribution.</p> <p>GUNTUR DIST.- Macherla Distribution, Gurajala, Distribution, Dachevallli Distribution, Piduguralla Distribution</p> <p>ONGOLE DIST.- Cheemakurthy Distribution, Maddipadu Distirbution</p> <p>NELLORE DIST.- Tada Distribution, Muthhukur Distribution, Chillakur Distribution, Menakur Distribution, Kodavalur Distribution</p> <p>CHITTOOR DIST.- Renigunta. Distribution, Gajula Mandyam distribution, Kuppam Distribution, Satyavedu Distribution,</p>		

	KADAPA DIST.- Yerraguntla Distribution, Mangampeta Distribution, Jammalamadugu Distribution		
	ANANTAPUR DIST:- Hindupur Distribution, Tadipatri Distribution, Anantapur Distribution, Guntakal Distribution, Rayalcheruvu Distribution, Yadiki Distribution		
	KURNOOL DIST :- Adoni Distribution, Dhone Distribution, Cement Nagar Distribution, Nandyal Distribution, Kurnool Distribution, Yemmiganur Distribution & Bethamcherla Distribution		
	NOTE:- If more than one area allowance(Such as those) for (1) Corporations (2) Municipalities and District Head Quarters (3) Industrial Area are applicable for a particular situation, only the maximum out of the allowable percentages is to be allowed.		

## II. IMPORTANT NOTE

- (1) Specific approval is to be taken from the corporate office in respect of blasting works.
- (2) Extra percentage is not allowed for LC Period works / shut down period works.
- (3) 9.1m/280 Kg Poles shall be utilized in Towns and 33 KV lines only.
- (4) All Fabrication works should be done by using departmental materials within stores Yard / premises only. Department materials shall not be issued to the out side the stores for fabrication purpose. Divisional Engineer / Tech shall personally monitor the issue of fabrication of materials.
- (5) All the estimates shall be prepared based on the rates of SSR only. For the items not covered in the SSR, approval is to be taken from the concerned SE, Operation.
- (6) Pole pit concreting is normally not allowed for PSCC/Spun poles. If concreting is to be done in certain cases, then specific approval is to be taken from the concerned SE, Operation.
- (7) Basic/Bed concreting is necessary for spun poles, if pole pit concreting is allowed.
- (8) Red oxide primer painting is not allowed in respect of old structures/equipment in 33/11 KV SS. Only one coat of aluminum/synthetic/ black bitumen paint is allowed.
- (9) No extra percentage/rate towards area allowance in respect of (a) loading & unloading charges (b) Fabrication of line materials (c) Dismantling and re-erection of Single Phase/Three Phase services is allowed
- (10) Specific approval is to be taken from the corporate office in respect of excavation of pits in soils other than the specified in SSR duly certifying the classification of soil by the concerned ADE / Civil and EE / Civil.

### III. RATES OF WORKS

#### I. RATES OF WORKS

SI No.	SAP Service code	Description	Unit	Rate
		<b>EXCAVATION OF PITS</b>		
1)		Excavation of pits <b>in all soils</b> i.e., mixture of gravel and soft disintegrated rock like shales ordinary gravel, stony earth and earth mixed with fair sized boulders.		
a)	<b>SSR00001</b>	2' x 2'6" x 5' or 0.6m x 0.75m x 1.5m (for 8m or 9.1m PSCC poles)	Pit	248.50
b)	<b>SSR00002</b>	2' x 2'6" x 5'6" or 0.6m x 0.75m x 1.65m (for 10m Joists/ rail poles)	Pit	263.70
c)	<b>SSR00003</b>	3' x 3' x 6' or 0.9m x 0.9m x 1.8m. (for 11m spun/Joist poles)	Pit	291.80
d)	<b>SSR00004</b>	3' x3' x 7' or 0.9m x 0.9m x 2.1m. (for 12.5 spun poles)	Pit	336.40
2)		Excavation of pits in excavation <b>in soft disintegrated rock removable by pick axes</b>		
a)	<b>SSR00005</b>	2' x 2'6" x 5' or 0.6m x 0.75m x 1.5m (for 8m or 9.1m PSCC poles)	Pit	277.70
b)	<b>SSR00006</b>	2' x 2'6" x 5'6" or 0.6m x 0.75m x 1.65m (for 10m Joists/ rail poles)	Pit	291.80
c)	<b>SSR00007</b>	3' x 3' x 6' or 0.9m x 0.9m x 1.8m. (for 11m spun/Joist poles)	Pit	322.20
d)	<b>SSR00008</b>	3' x3' x 7' or 0.9m x 0.9m x 2.1m. (for 12.5 spun poles)	Pit	364.50
3)		Excavation of pits <b>in hard rock by blasting</b>		
		<b>Note:- 1) Specific approval is to be taken from the corporate office in respect of blasting works.</b>		
		<b>2) Quantity of excavation actually done as per specification and plans only is to be admitted, irrespective of total excavation of the pit.:-</b>		
a)	<b>SSR00009</b>	2' x 2'6" x 5' or 0.6m x 0.75m x 1.5m (for 8m or 9.1m PSCC poles)	Pit	876.70
b)	<b>SSR00010</b>	2' x 2'6" x 5'6" or 0.6m x 0.75m x 1.65m (for 10m Joists/ rail poles)	Pit	963.40
c)	<b>SSR00011</b>	3' x 3' x 6' or 0.9m x 0.9m x 1.8m. (for 11m spun/Joist poles)	Pit	1891.60
d)	<b>SSR00012</b>	3' x3' x 7' or 0.9m x 0.9m x 2.1m. (for 12.5 spun poles)	Pit	2206.90

e)	SSR00013	Rate per cft	cft	35.10
		<b>ERECTION OF LINES</b>		
4)		<b>PSCC/SPUN/RAIL POLES ERECTION</b> :-Erection of PSCC Poles in position aligning and setting to work as per specification including supply of labour for survey, pit- marking, T&P, transport of 1 No. PSCC Pole from road side upto 1KM to location including loading and unloading and back filling the earth ramming for consolidation but excluding the cost of pit excavation.		
		<b>PSCC Poles</b>		
a)	SSR00050	8.0 m /140 Kg PSCC Poles ( Weight of pole=355 Kg)	Each	949.30
b)	SSR00051	8.0 m /200 Kg PSCC Poles ( Weight of pole=380 Kg)	Each	1016.20
c)	SSR00052	8.0 m /300 Kg PSCC Poles ( Weight of pole=505 Kg)		
d)	SSR00053	9.1 m / 280 Kg PSCC poles ( Weight of pole=680 Kg)	Each	1817.80
e)	SSR00054	11.0 m / 365 Kg PSCC poles ( Weight of pole=1127 Kg)	Each	3068.20
		<b>Spun poles</b>		
f)	SSR00055	9.5 m Spun Pole ( Weight of pole=620 Kg)	Each	2688.50
g)	SSR00056	11.0 m Spun poles ( Weight of pole=900 Kg)	Each	3902.80
h)	SSR00057	12.5 m Spun Poles ( Weight of pole=1,200 Kg)	Each	5203.70
		<b>Rail Poles</b>		
i)	SSR00058	60 Lbs / 27.3kg-. Rail poles- Length of Rail pole – 27'(8.23m) ( Weight of pole=225 Kg)	Each	602.40
j)	SSR00059	75 Lbs / 34.1kg. Rail poles- Length of Rail pole – 30'(9.14m) ( Weight of pole=312 Kg)	Each	834.50
k)	SSR00060	90 Lbs / 40.9kg. Rail poles- Length of Rail pole – 30'(9.14m) ( Weight of pole=374 Kg)	Each	999.70
l)	SSR00061	105 Lbs / 47.7kg. Rail poles- Length of Rail pole – 30'(9.14m) ( Weight of pole=436 Kg)	Each	1162.60
		<b>RS Joist Poles</b>		
m)	SSR00062	150x75 RS Joist Poles –Length of Joist – 9M ( Weight of pole=140 Kg)	Each	372.70
n)	SSR00063	175x85 RS Joist Poles –Length of Joist – 9M ( Weight of pole=215 Kg)	Each	574.30
o)	SSR00064	150x150 RS Joist Poles –Length of Joist – 9M ( Weight of pole=333 Kg)	Each	887.20



<b>Note:-</b>		Add extra for lead 1KM to 1.5KM	MT	142.00
		Add extra for lead 1KM to 2.0KM	MT	284.00
		Add extra for lead 1KM to 2.5KM	MT	406.00
<b>5)</b>		<b><u>STAY SET ERECTION</u></b>		
<b>a)</b>	<b>SSR00080</b>	<b><u>Stay erection (33 KV line or 11 KV line or LT Line)</u></b> <b><u>Data for each Stay set :-</u></b> Assembly and erection of Stay set made out of M.S. Rod 20 mm by burying Stay Rods with base plate in alignment with line / bisection, back billing with earth and ramming for Consolidation including fixing of guy in Stay wire of 7/12 clamps, turn buckles etc., on the Pole and binding on either side and as per specification and transporting materials and T&P from road side to work spot including loading and unloading, but excluding cost of pit excavation.	Set	281.30
<b>6)</b>		<b><u>ERECTION OF CROSS ARMS</u></b>		
<b>a)</b>	<b>SSR00081</b>	<b><u>Fixing of 1 No. 5' – 0" – Channel ( 100 X 50 mm) – V – X – Arms for 33 KV:-</u></b> Fixing of 1 No. 5' – 0" – Channel ( 100 X 50 mm) – V – X – Arms ( for 33 KV line) to already erected 9.1 M PSCC with 1 No. Back Clamp made out of 75 X 8 mm M.S. Flat including transporting of materials and T&P from road side to location with loading and unloading	Each	116.10
<b>b)</b>	<b>SSR00082</b>	<b><u>Fixing of 33 KV Top fitting :-</u></b> Fixing of 1 No. 33 KV Top – fitting ( MS Channel 100 X 50 mm ) with 2 Clamps ( MS flat 75 X 8 mm) to the already erected 9.1 M PSCC Pole including transporting of materials and T&P from road side to location with loading and unloading.	Each	53.90
<b>c)</b>	<b>SSR00083</b>	<b><u>Fixing of 11 KV 3' – 6" – V – X- Arm :-</u></b> Fixing of 1 No. 3' – 6" – V – X – arm made out of M.S. Channel 75 X 100 mm to the already erected 8M PSCC Pole with 1 No. Back Clamp made out of 75 X 8 mm M.S. Flat as per specification and drawing aligning them properly and setting to work including transporting of materials and T&P from road side to location with loading and unloading	Each	69.20
<b>d)</b>	<b>SSR00084</b>	<b><u>Fixing of 11 KV Top – Fittings :-</u></b> Fixing of 1 No. 11 KV Top – fittings made out of 65 X 65 X 6 mm Angle to the already erected 8M PSCC Pole with 2 Nos. B.Cs made out of 50 X 6 mm MS Flat as per specification and aligning them properly and setting to work including transporting from road side to location loading and unloading	Each	42.20
<b>e)</b>	<b>SSR00085</b>	<b><u>Fixing of LT 3 phase/ Single phase 'X' Arm:-</u></b> Fixing of 1 No. LT 3 phase/single 'X' –arms with 1 No. back clamp to the erected all types of poles as per specification and drawing aligning them properly and setting to work including transporting of materials and T&P from road side to location with loading and unloading	Each	49.30

f)	SSR00086	<b><u>Fixing of L.T. Top fitting :-</u></b> Fixing of 1 No. L.T. Top fitting made out of M.S Angle 50X50X6 mm to the already erected 8M PSCC Pole with 2 Nos. back Clamps made out of M.S. Flat as per specifications and drawing aligning them properly and setting to work including transporting of material and T&P from road side to location with loading and unloading.	Each	32.90
g)	SSR00087	<b>Fixing of 11 KV/ LT side arm with strut</b>	Each	116.10
h)	SSR00088	<b>Fixing of 11 KV/ LT box type side arm with strut</b>	Each	150.00
7)		<b><u>FIXING OF INSULATORS</u></b>		
a)	SSR00100	<b><u>Fixing one No. 33 KV Insulator and Pin:-</u></b> Fixing of 33 KV Insulator as per the specification and drawing and aligning them properly to work, transportation of 33 KV insulators and pin from road side to location including loading and unloading	Each	44.50
b)	SSR00101	<b><u>Fixing of 33 KV Discs with MPS ( i.e., 3 Nos. Discs and 1 set MPS ).</u></b>	1 set	151.20
c)	SSR00102	<b><u>33 KV Polymer disc</u></b>	Each	76.20
d)	SSR00103	<b><u>Fixing 1 No. 11 KV Disc with MPS :-</u></b> Fixing of 11 KV metal part along with 11 KV Disc to Cross arm as per specification and drawing aligning them properly and setting to work, transporting of materials and T&P from road side to location including loading and unloading	Each	62.10
e)	SSR00104	<b><u>11 KV Polymer disc</u></b>	Each	32.90
f)	SSR00105	<b><u>Fixing of one 11 KV Pin insulator &amp; Pin :-</u></b>	Each	28.10
g)	SSR00106	<b><u>Fixing of LT Pin Insulators &amp; GI Pins, LT shackles with MPS and CI Knobs</u></b>	Each	28.10
8)	SSR00107	<b><u>Erection of Line D.P.S</u></b> :-Assembly, erection, aligning line, D.P. Structure and setting to work as per drawing general specifications including transport of materials and T&P from road side to location, loading and unloading, providing of watch and ward till the line pre – handed over but excluding the cost of pit excavation :-		
9)	SSR00108	<b><u>STRUT - ERECTION</u></b>		

10)(i)		<b><u>Paving , Stringing &amp; Jumpering of Conductor :-</u></b> Fixing of suitable rollers, bamboos, paving out Conductor on suitable supports, providing temporary stays, tensioning, sagging correctly, fixing at strain point, transporting to pin points, binding, rectification of poles, guys and jumpering as per specification and drawing or various Conductors including transporting of materials and T&P from road side to location including loading and unloading and providing watch and ward till the lines are handed over( <b>Rate per Km/Per conductor</b> )		
a)	SSR00130	Dog conductor weighing 393Kg/Km	Per Km/C	<b>Deleted</b>
b)	SSR00131	100 sq.mm.AAA weighing 272.86 Kg/Km	Per Km/C	6101.40
c)	SSR00132	7/3.35 ACSR or 55 sqmm., AAA conductor weighing 149.2 Kg/Km	Per Km/C	3337.60
d)	SSR00133	7/2.59 ACSR or 34 sqmm., AAA conductor weighing 94 Kg/Km	Per Km/C	2100.20
10)(ii)		<b><u>Paving\, Stringing &amp; Jumpering of Cable :-</u></b> Fixing of suitable rollers, bamboos, paving out cable on suitable supports, providing temporary stays, tensioning, sagging correctly, fixing at strain point, transporting to pin points, binding, rectification of poles, guys and jumpering as per specification and drawing of various cables including transporting of materials and T&P from road side to location including loading and unloading and providing watch and ward till the lines are handed over( <b>Rate per Km</b> )		
a)	SSR00140	AB cable 1x16 + 25mm. weighing 120 Kg/Km	Per Km	2682.40
b)	SSR00141	AB cable 2x16 + 25mm weighing 189 Kg/Km	Per Km	4228.60
c)	SSR00142	AB cable 3x16+25mm weighing 258 Kg/Km	Per Km	5769.80
d)	SSR00143	185 sqmm 11 KV AB cable	Per Km	<b>Deleted</b>
11)		<b><u>CONCRETING ITEMS :-</u></b> Note:- 1) Pole pit Concreting is normally not allowed for PSCC/Spun poles. If concreting is to be done in certain cases, then specific approval is to be taken from the concerned SE, Operation. 2) Basic /Bed concreting is necessary for spun poles, if pole pit concreting is allowed. 3)All concreting items are to be worked out as per Govt. SSR by the respective circle office ADEs/CIVIL		
a)		<b><u>Concreting of pole pit</u></b>		

		Concreting of pole pit of size =2'x2'6"x5' (0.6m x 0.75m 1.5 m.) with C.C.(1:4:8) using 40 mm. HBG metal including cost and Transport of all materials, labour charges, Transport of T & P and labour etc..		
i)		Labour charges in Rural areas		
ii)		Material(40mm HBG Metal + sand ) up to 5Km lead		
iii)		Cement		
iv)	<b>SSR00170</b>	Total (Labour + Material + Cement)		
b)		<b><u>Concreting of stay pit</u></b>		
		Concreting of stay pit of size 1' x 1'-6" x 4' (0.3mx0.45x1.2m) with C.C. (1:4:8) using 40 mm., HBG metal including cost and Transport of all materials, labour charges all leads & lifts etc.,		
i)		Labour charges in Rural areas		
ii)		Material(40mm HBG Metal + sand )		
iii)		Cement		
iv)	<b>SSR00171</b>	Total (Labour + Material + Cement)		
c)		<b><u>Construction of 1No. VCB plinth of size 5'6" x 5'x 3'6"</u></b>		
		Excavation of pit of size 5'6"x5'x3', filling with sand for 6" depth, laying bed concrete with CC(1:4:8) using 40mm HBG metal for 4" depth, Construction of VCB plinth of size 5'6" x 5'x 3'6" (1.65m x 1.5m x 1.05m) with CC (1:3:6) mix using 40 mm HBG metal and providing plastering in CM (1:5) 12mm thick for top and sides above G.L. portion and white washing two coats including cost and Transport of all materials and labour charges for all operations with an average lead of 5KM and lifts etc., complete as directed by the Engineer in charge		
i)		Labour charges in Rural areas		
ii)		Material (40mm HBG Metal + sand +Janatha cem + Centering material hire charges)		
iii)		Cement		
iv)	<b>SSR00172</b>	Total (Labour + Material + Cement)		
d)		<b><u>Construction of 1No. Distribution transformer plinth of size 4'x4'x5'6" with brick masonry walls/RR Masonry wall:-</u></b>		
		Excavation of pit of size 4'x4'x2', filling with sand for 1' depth, laying bed concrete with CC(1:4:8) using 40mm HBG metal for 4" depth, Construction of distribution transformer plinth with 9" thick 5'10" height brick masonry wall in CM (1:6) all-round, filling the hollow portion with sand, laying of 4" thick PCC (1:3:6) using 20 mm HBG metal on top and plastering all-round the outer side of wall with CM (1:5) 12mm thick and white washing two coats, including cost and Transport of all		

		materials and labour charges for all operation with an average lead of 5 KM and lifts etc., complete as directed by the Engineer in charge.		
i)		Labour charges in Rural areas		
ii)		Material (Bricks+ 40mm and 20mm HBG Metal + sand +Janatha cem cem + Centering material hire charges) up to 5Km lead		
iii)		Cement		
iv)	<b>SSR00173</b>	Total (Labour + Material + Cement)		
12)		<b><u>Construction of pillar mounted. Distribution transformer plinth using RCC:-</u></b>		
		Excavation of pit of size 5'x5'x5', filling with sand for 4"( 10 cm) depth, laying bed concrete with CC(1:4:8) using 40mm HBG metal for 4" depth, Construction of distribution transformer plinth with footing size (5'x5'x4" and 3'x3'x1.5'), column size 9"x9"x8'8", beam size 9"x9"x9'3", slab size 5'x5'x4", providing reif steel 12mm rod (76 Kgs) as per the directions of ADE/Civil, re-filling the hollow portion with excavated earth, and slabs, column and beam with CM (1:5) 20mm thick, including cost and Transport of all materials and labour charges for all operation with an average lead of 5 KM and lifts etc., complete as directed by the Engineer in charge.		
i)		Labour charges in Rural areas		
ii)		Material ( 40mm and 20mm HBG Metal + sand + Centring material hire charges) up to 5Km lead		
iii)		Cement		
iv)		Steel		
	<b>SSR00174</b>	Total (Labour + Material + Cement+ steel)		
13)		<b><u>Construction of 1No. Distribution transformer plinth of size 4' dia and 6' height using RCC rings:-</u></b>		
		Excavation of pit of size 4' dia 1'6" depth , laying one 40mm thick RCC cover on bottom/ground, laying seven RCC rings ( dia 4' and 1'height each) over RCC cover, filling the hollow portion with sand, providing 4" thick RCC cover on top and pointing all the joints with CM(1:5) including cost of all materials and labour charges.		
i)		Labour charges		

ii)		Material (Sand+ RCC rings+ RCC covers)		
iii)		Cement		
iv)	SSR00175	Total (Labour + Material+ cement )		
14)	SSR00200	<b>Erection of 33/11 KV VCB:</b> Erection & Setting of 33/11 KV VCB with control panels on plinth carefully without causing any damages to bushings including transport, loading and unloading charges of VCB, Control cables, CTs and T&P etc labour charges complete including panel board wiring, testing and commissioning charges	Each	16940.40
15)	SSR00201	<b>Erection of 33 KV AB Switch:</b> Erection of 33 KV AB Switch on the booms including T&P and labour charges complete as per Dept standards	Set	1838.60
16) a)	SSR00202	<b>a) Erection of 11 KV 400 Amps AB Switch:</b> Erection of 11 KV 400 Amps AB Switch on the booms including T&P and labour charges complete as per Dept standards	Set	1378.40
16) b)	SSR00203	<b>b) Erection of 11 KV AB Switch &amp; HG Fuse set:</b> Erection of AB Switch & HG Fuse set including transport from section office to work site, T&P labour charges complete as per department standards	Set	1732.90
17)		<b>Wiring of 3 Phase Distribution Transformer (100/63 KVA):</b> Wiring of 3 phase Distribution Transformer (100/63 KVA) with 95 Sqmm PVC Cable/conductor from transformer LV bushing to LT HG Fuse set and HG Fuse set to line with bear conductor supported on insulator fixed to fabricated LV frame		
a)	SSR00210	Single Feeder with PVC cable	Each	1635.90
b)	SSR00211	Double Feeder with PVC cable	Each	3273.00
c)	SSR00212	Single Feeder with open wiring	Each	1635.90
d)	SSR00213	Double Feeder with open wiring	Each	3273.00
18)	SSR00220	Erection of pole mounting structure for erection of Single Phase / Three Phase Transformers	Each	291.80
19)		<b>Transformers Erection:</b> Erection of Distribution Transformer on the plinth/pole carefully without causing and damaged to bushing including labour and transport complete		
a)	SSR00221	Single phase transformers 5 KVA on pole mounting structure	Each	583.70
b)	SSR00222	Single phase transformers 15 KVA on pole mounting structure	Each	876.20
c)	SSR00223	Three phase transformers 16/25KVA on pole mounting structure	Each	1167.10

d)		<b><u>Transformers from 50 KVA to 160 KVA</u></b>		
i)	SSR00224	On plinth	Each	1459.20
ii)	SSR00225	On structure		
e)		<b><u>Transformers from 250 KVA to 315 KVA</u></b>		
i)	SSR00226	On plinth	Each	1750.90
ii)	SSR00227	On structure		
f)		Erection/dismantling of healthy/sick PTR from plinth with accessories, radiators duly filling/drainng out the oil and dragging the sick PTR to convenient locations for transport including stacking of radiators and accessories		
i)	SSR00228	3.15MVA	Each	7095.60
ii)	SSR00229	5 MVA	Each	8868.40
iii)	SSR00230	8 MVA	Each	10643.40
g)		Erection of additional/new PTR including loading at Stores, unloading at site & erection of PTR at site.		
i)	SSR00231	3.15MVA	Each	21285.70
ii)	SSR00232	5 MVA	Each	26606.30
iii)	SSR00233	8 MVA	Each	31927.90
h)		Replacement of sick PTR including loading of healthy PTR at Stores, unloading of healthy PTR at site, dismantling of sick PTR at site, Erection/commissioning of new PTR, loading of sick PTR at site and unloading of sick PTR at Stores etc.		
i)	SSR00234	3.15MVA	Each	42570.20
ii)	SSR00235	5 MVA	Each	53213.60
iii)	SSR00236	8 MVA	Each	63855.90
20)		<b><u>Erection of tilting/ horizontal type 11 KV AB Switch:-</u></b> Transporting of 11 KV tilting/horizontal type AB switch complete and required metallic supporting channels & studs for fixing to single pole structure so as to erect 11 KV tilting/horizontal type ABs and other parts connected to erection of the same from road side to location including loading & unloading. Erection of 11 KV tilting/horizontal type AB switch, on supporting channels, studs fitted to the pole set into operate freely i.e., opening & closing by fixing required number of guide angles, to pole and vertical operating pipe with handle including coil earthing of 11 KV tilting/horizontal type ABS handle as per standards. All the materials supplied by Department		
a)	SSR00250	Erection of tilting type 11 KV AB Switch to Single pole DP Structure:-	Each	1094.90

b)	SSR00251	Erection of horizontal type 11 KV AB Switch on DP Structure:-	Each	1224.30
21)		<b><u>Erection of Earth Electrodes:</u></b>		
		Erection of earth electrodes using CI/GI pipes including pit excavation, and cement collar of 2'dia x 1' height etc complete.		
21) a)	SSR00252	a)GI Pipes	Each	657.40
21) b)	SSR00253	b)CI Pipes	Each	804.00
		Note:- In case GI/C.I Pipes are procured by the Contractor then 12% over SPDCL stores rate can be allowed for pipe cost .		
22)	SSR00254	<b><u>Erection of 33 KV HG Fuse set at Single Pole DTR Structure:-</u></b> Transporting of 33 KV H.G. Fuse set materials like post type insulators, Horns, pedestals etc., with seating Angles/Channels, made out of M.S. Angle from road side to location including loading & unloading and erection of 33 KV HG fuse set at required height as per standards with connected angles & Channels by adjusting the Horns to the required gap at single pole DTR structure. All the materials supplied by Departments.	Set	700.50
23)	SSR00255	<b><u>Erection of 11 KV HG Fuse set at Single Pole DTR Structure:-</u></b> Transporting of 11 KV H.G. Fuse set with seating Angles/Channels, side arms, made out of M.S. Angle with MS. Angle stud from road side to location including loading & unloading and erection of 11 KV HG fuse set at required height as per standards with connected angles & Channels by adjusting the Horns to the required gap at single pole DTR structure. All the materials supplied by Departments.	Set	291.80
24)	SSR00256	<b><u>Erection of LT Fuse set at Single Pole DTR Structure:-</u></b> Transporting of LT Fuse set with seating Angles/Channels, side arms, made out of M.S. Angle with MS. Angle stud from road side to location including loading & unloading and erection of LT fuse set at required height as per standards with connected angles & Channels by adjusting the Horns to the required gap at single pole DTR structure. All the materials supplied by Departments.	Set	217.70
25)	SSR00257	<b><u>Earthing of Distribution Transformers:</u></b> Running of No 8 G.I wire from Distribution Transformer (3 Phase) AB Switch, HG Fuse Set V'X' Arm etc running of 14 SWG G.I. Wire including double earthing as per specification for running of total 10 Nos GI wires.	Per Lead Per length	22.30



		Note:- In case GI wire is procured by the Contractor then 12% over SPDCL stores rate can be allowed for GI wire cost.		
26)		<b>Paving out and laying of 33KV/11 KV UG cable</b> duly forming the cable trench including excavation of trench 2'X2' filling the trench with excavated earth including transporting of cable etc. complete with out construction of trench.		
a)	<b>SSR00270</b>	33 KV UG cable	RM	322.20
b)	<b>SSR00271</b>	11 KV UG cable	RM	174.60
27)	<b>SSR00272</b>	Labour charges for erection of <b>11 KV cable heat shrunken joint</b>	Each	4379.80
28)	<b>SSR00273</b>	Labour charges for erection of <b>33 KV cable heat shrunken joint</b>	Each	5837.90
29)	<b>SSR00274</b>	<b>11 KV AB cable end termination</b> consisting of 3 phases.	Set	7298.20
30)		Labour charges for <b>erection of 33 or 11 KV C.Ts</b> including all connections.		
a)	<b>SSR00275</b>	33 KV CTs	Each	467.70
b)	<b>SSR00276</b>	11 KV CTs	Each	322.20
31)	<b>SSR00277</b>	Labour charges for erection of <b>HT metering cubicle</b> including all connections and earthing as per departmental standards.	Each	731.30
32)	<b>SSR00278</b>	Labour charges for erection of <b>HT Trivector meter box</b> including all connections and earthing as per departmental standards.	Each	467.70
33)	<b>SSR00279</b>	Dismantling and Re-erection of Single Phase/ Three Phase services ( Any where in the district same rate only. NO EXTRA RATE TOWARDS AREA ALLOWANCES IS ALLOWED)	One Service	25.90
34)		Extra percentage towards work involving (a) Single Pole (b) Two Pole (c) Three Poles (This rate is applicable to both Urban and Rural areas)		
a)		Single Pole		100% Extra
b)		Two Poles		50% Extra
c)		Three Poles		20% Extra
35) a)		(a) Labour charges for rectification of all types of leaned poles where the lean is more than 30 degree to the vertical.	35% of Erection Charges	

35) b)		(b) Charges for restringing of loose spans	50% of stringing charges	
36)	SSR00300	Labour charges for fixing of tube light fitting for street light	Each	146.60
37)	SSR00301	Labour charges for fixing of MV/SV lamp fitting for street light	Each	161.70
38)		Laying of earth mat/risers including excavation of trenches, welding, fixing lugs, connecting to equipment and refilling trenches using MS flat 75x8mm or 50x8mm.		
a)	SSR00302	75x8mm	RM	67.90
b)	SSR00303	50x8mm	RM	45.30
39)		<p>Providing <b>security fencing</b> of size 2.4m x 3m x3m (total area 28.8 sqm) <b>to Distribution Transformer structures</b> with gate and locking arrangement which is one side removable and three sides fixed fencing as per the dimensions mentioned in the drawing using G.I. Chain link mesh 8 guage 50.8mm x 50.8mm (2" x 2") size, MS angle 50 x 50 x 6, MS flat 35 x 6, MS flat 25 x 6, bolts, nuts, Aldrop, hinges, concreting the supports with PCC (1:4:8), painting one coat red oxide, two</p> <p>coats synthetic enamel paint, complete for finished item of work.</p> <p>Note:- Works are to be executed on seeking estimate sanction from the corporate office.</p> <p>Whenever it is not possible to provide fencing of size 2.4mx3mx3m, then size may be reduced and payment may be arranged based on the actual area.</p>		
a)	SSR00304	Rural areas	Sqm	1100.30
b)	SSR00305	All other areas	Sqm	1126.20
		<b><u>Painting of Old or new structures/ equipment in 33/11 KV SS</u></b>		
40)		<b>Painting of old/new structures with one coat of aluminium paint</b> including cost and conveyance of paints, brushes, labour complete.		

a)	SSR00320	Cost of paint	Sqm	30.00
b)	SSR00321	Labour charges	Sqm	42.00
c)	SSR00322	Total (Cost of paint + labour charges)	Sqm	73.00
d)	SSR00323	Cost of paint	MT	1675.00
e)	SSR00324	Labour charges	MT	2333.00
f)	SSR00325	Total (Cost of paint + labour charges)	MT	4007.00
41)		<b>Painting of old/new equipment</b> including transformers, VCBs, breakers with <b>one coat of synthetic enamel paint</b> including cost and conveyance of paints, brushes, labour complete.		
a)	SSR00326	Cost of paint	Sqm	23.90
b)	SSR00327	Labour charges	Sqm	42.40
c)	SSR00328	Total (Cost of paint + labour charges)	Sqm	66.00
d)	SSR00329	Cost of paint	MT	1316.00
e)	SSR00330	Labour charges	MT	2333.00
f)	SSR00331	Total (Cost of paint + labour charges)	MT	3649.00
42)		<b>Painting of old/new structures with one coat of Anti corrosive bitumen black paint</b> including cost and conveyance of paints, brushes, labour complete.		
a)	SSR00332	Cost of paint	Sqm	44.60
b)	SSR00333	Labour charges	Sqm	42.40
c)	SSR00334	Total (Cost of paint + labour charges)	Sqm	87.00
d)	SSR00335	Cost of paint	MT	2452.00
e)	SSR00336	Labour charges	MT	2333.00
f)	SSR00337	Total (Cost of paint + labour charges)	MT	4785.00
43)		<b>Painting of new structures/ equipment</b> in 33/11 KV SS with <b>one coat of Red oxide paint and two coats of aluminum paint.</b>		
a)	SSR00338	Cost of paint	Sqm	93.30
b)	SSR00339	Labour charges	Sqm	75.00
c)	SSR00340	Total (Cost of paint + labour charges)	Sqm	168.80
d)	SSR00341	Cost of paint	MT	5144.00

e)	SSR00342	Labour charges	MT	4127.00
f)	SSR00343	Total (Cost of paint + labour charges)	MT	9271.00
44)		<b>Painting of new structures/ equipment in 33/11 KV SS with one coat of Red oxide paint and two coats of synthetic enamel paint.</b>		
a)	SSR00344	Cost of paint	Sqm	75.00
b)	SSR00345	Labour charges	Sqm	75.00
c)	SSR00346	Total (Cost of paint + labour charges)	Sqm	150.00
d)	SSR00347	Cost of paint	MT	4127.00
e)	SSR00348	Labour charges	MT	4127.00
f)	SSR00349	Total (Cost of paint + labour charges)	MT	8254.00
		<b>DISMANTLING</b>		
45)		For all <b>dismantling works 50%</b> of erection charges shall be adopted. For poles dismantling charges at 50% is allowed only, if they are retrieved in good condition.		
		<b>MRT WORKS</b>		
46)	SSR00400	Labour for <b>opening of the top cover of CSP Transformer</b> by cutting with grinder and welding/fixing with bolts and nuts of the top cover for various capacities of Distribution transformers ie.,63 KVA,100KVA 250 KVA and 500 KVA at SPM shed inclusive of cost of welding electrodes, cost of bolts and nuts and drilling of holes	Each	1837.50
47)	SSR00401	Labour charges for <b>reclamation of used transformer oil</b> at MRT shed	Kilo litre	5253.80
48)	SSR00402	<b>Providing of MS vent pipe with diaphragm to the top cover of the D.Tr.</b> The vent Pipe consists of 50mm dia, 4mm thick copper foil should be fixed between flange of the Nipple and 180 bend. Wire gauge protection should be provided at the end of the bend Duly providing flange.	Each	1110.00
		Note:- For the above three items of work the required machinery and material except general consumables such as cotton waste etc., shall be supplied by the Dept at free of cost		
49)		Handling, testing, providing of seals with cover, stacking neatly.		
a)	SSR00403	S phase energy meter.	Each	11.70
b)	SSR00404	Testing of 3 Phase energy meter	Each	19.90

50)		Removing the meter back cover, cleaning the old meter cover, painting the meter top & bottom covers with good approved enamel black paint, cleaning the meter with petrol and oiling to bearings with good 2 in 1 oil (Usha make) refixing the meter in meter cover duly providing new gaskets. Testing and adjustments of the meter as per departmental standards, loading, transporting, and unloading including introducing sealing wire to each meter including replacement of glass wherever necessary.		
a)	SSR00405	Including cost of paint	Each	30.50
b)	SSR00406	Excluding cost of paint	Each	22.30
51)	SSR00407	Removal or fixing of PC coil, CC coil or Disc, cyclometer or terminal block.	Each	3.60
52)		Labour charges for sealing of single phase/3 phase meters including transportation of meter box carton to work spot, unpacking, packing of sealed meters and stocking etc., complete.		
a)	SSR00408	2 Seals	Each	6.50
b)	SSR00409	3 Seals	Each	7.00
c)	SSR00410	4 Seals	Each	10.60
53)		Labour charges for sealing of S Phase/ 3 phase energy meters housed in PP box including transportation unpacking and packing and stocking of meter box etc., complete.		
a)	SSR00411	2 Seals	Each	7.00
b)	SSR00412	3 Seals	Each	12.90
c)	SSR00413	4 Seals	Each	16.40
d)	SSR00414	6 Seals	Each	25.80
54)		<b><u>Metering arrangement with CTs to 16/25 KVA Agricultural DTRs</u></b>		
a)	SSR00415	Supply and rigging of meter with country wood of size 1'x1/2', 7/20 finolex wire, bolts and nuts and screws along with lugs. Removing of metallic strip in syntex box, fixing of wooden board suitably, fixing of meter and CT in position including fixing of neutral terminal bolt. Providing of internal wiring duly giving proper connections, opening of internal link in the meter duly providing sealing after testing. ( energy meter and box will be supplied by the dept)	Each	758.30

b)	SSR00416	Supply and fixing of 2meters of aluminium cable, 05m of 3/20 copper wire, 2 sets of clamps with bolts and nuts and misc items like insulation tapes, screws etc., including labour charges for fixing of box and transport charges including loading and unloading.	Each	349.20
	SSR00417	.do. with 4 sets of clamps	Each	409.00
		<b><u>FABRICATION OF LINE MATERIALS:-</u></b>		
		<b>Important Note:.</b> (1)All the fabrication works should be done by using department materials within stores yard/premises only. Department Materials shall not be issued to the out side the stores, for fabrication purpose. Divisional Engineer/ Tech shall monitor the issue of fabrication material.		
		<u>(2) No extra rate towards area allowance is allowed in respect of fabrication of line materials</u>		
		<u>(3)Fabrication rates are inclusive of cost of Power, welding rods, Oxygen and Acetylene for cutting, welding and cutting charges, bending charges, drilling charges, red oxide paint. In case any of the above mentioned items are done in our dept workshop with the help of machinery, material and staff then accordingly rate is to be reduced from these approved rates.</u>		
55)		<b>CUTTING CHARGES:-</b>		
a)	SSR00500	60 lbs. Rail poles	Each	37.50
b)	SSR00501	90 lbs. Rail poles	Each	58.60
c)	SSR00502	105 lbs. Rail poles	Each	58.60
d)	SSR00503	R.S. Joists of various sizes	Each	29.30
e)	SSR00504	M.S. Channels of size 75 x 40 mm. and 80 x 40 mm	Each	9.40
f)	SSR00505	M.S. Channels of size 100 x 50 mm. and 125 x 65 mm	Each	10.60
g)	SSR00506	M.S. Channels of size 150 x 75 mm. and above	Each	15.20
h)	SSR00507	M.S. Angles of sizes 50 x 50 x 6 mm. and 55 x 55 x 5 mm.	Each	4.70
i)	SSR00508	M.S. Angles of size 65 x 65 x 6 mm. and above	Each	5.80
j)	SSR00509	M.S. Flat 75 x 8 mm.	Each	3.60

k)	SSR00510	M.S. Flat of size 50 x 6 mm.	Each	3.60
l)	SSR00511	M.S. Flat of width below 50 mm.	Each	2.40
m)	SSR00512	M.S. Rounds up to 23 mm.	Each	3.60
56)		<b><u>DRILLING CHARGES</u></b>		
a)		Charges for drilling of holes to various sizes of angle, channel and flats.		
i)	SSR00530	For holes up to 18 mm.	Each	3.60
ii)	SSR00531	For holes above 18 mm	Each	4.70
b)		Drilling of holes of various sizes to R.S. Joists and Rail poles with ratchet or hand Drilling machine:		
i)	SSR00532	For R.S. Joists	Each	5.80
ii)	SSR00533	For 60 lbs. Rail poles	Each	6.50
iii)	SSR00534	For 90 lbs. Rail poles	Each	7.70
c)		Drilling of holes of various sizes to R.S. Joists or Rails poles using power drilling Machine:.		
i)	SSR00535	For R.S. Joists	Each	4.70
ii)	SSR00536	For 60 lbs. Rail poles	Each	5.80
iii)	SSR00537	For 90 lbs. And 120 lbs Rail	Each	7.00
57)		<b><u>FABRICATION CHARGES: Fabrication of the following materials including cost of consumables, cutting, drilling charges, but excluding the cost of raw materials</u></b>		
a)	SSR00550	<b>33 KV "V" Cross arms</b> with 100x50 mm MS Channel 2.08mtrs(6'.10") – Weight of the materials=19.0 Kg	Each	571.90
b)		<b>11KV "V" Cross arms .</b>		
i)	SSR00551	With 75x40 mm M.S. Channel . Weight of the materials = 9 Kgs.(with 4 nos 50x50x6 packing plates are welded)	Each	518.10
ii)	SSR00552	With 65x65x6mm M.S. Angle – . Weight of the materials =8.2 Kgs	Each	294.20
c)		<b>LT 3.Phase 4 Wire Cross arms.</b>		

i)	SSR00553	With 50x50x6mm M.S. Angle( 3'.8") . Weight of the materials = 5.75 Kgs.	Each	148.70
ii)	SSR00554	With 65x65x6mm M.S. Angle ( 3'.8") – Weight of the materials = 7 Kgs	Each	153.60
d)		<b>LT 3.Phse 5 Wire Cross arms .</b>		
i)	SSR00555	With 50x50x6mm M.S. Angle(4'.5")– Weight of the materials = 7.3 Kgs	Each	181.70
ii)	SSR00556	With 65x65x6mm M.S. Angle ( 4'.5") – Weight of the materials = 9.6 Kgs	Each	185.10
e)	SSR00557	<b>LT S.Phase 3 Wire Cross arms</b> with 50x50x6mm M.S. Angle (2'.5") = Weight of the materials = 4.2 Kgs.	Each	117.20
f)		<b>M.S. Stay sets</b>		
i)	SSR00558	<b>M.S. Stay sets with 20 mm M.S. Rod &amp; Stay Clamps with 100x50mm M.S. Channel .</b> Weight of the materials = 10.3 Kgs	Each	159.30
ii)	SSR00559	<b>M.S. Stay sets with 20 mm M.S. Rod &amp; Stay Clamps with 75 x40mm M.S. Channel .</b> Weight of the materials = 10.2 Kgs.	Each	148.70
iii)	SSR00560	<b>M.S. Stay sets with 16mm M.S. Rod &amp; Stay Clamps with 100x50mm M.S. Channel .</b> Weight of the materials = 8.0 Kgs	Each	151.20
iv)	SSR00561	<b>M.S. Stay sets with 16mm M.S. Rod &amp; Stay Clamps with 75x40xmm M.S. Channel .</b> Weight of the materials = 7.6 Kgs	Each	143.00
v)	SSR00562	<b>M.S. Stay sets with 16mm M.S. Rod &amp; Stay Clamps with 50x50x6mm M.S. Angle –</b> Weight of the materials = 6.3 Kgs	Each	136.90
g)		<b>33KV Top Fitting</b>		
i)	SSR00563	<b>33KV Top Fitting</b> with Clamps with 75x40mm M.S. Channel . Weight of the materials = 6.9 Kgs.	Each	159.50
ii)	SSR00564	<b>33KV Top Fitting</b> with Clamps with 65x65x6mm M.S. angle . Weight of the materials = 6.5 Kgs.	Each	143.00
h)		<b>11KV Top Fittings</b>		
i)	SSR00565	<b>11KV Top Fittings</b> with Clamps 65x65x6mm M.S. Angle – Weight of the materials = 4.4 Kgs.	Each	143.00
ii)	SSR00566	<b>11KV Top Fittings</b> with Clamps 50x50x6mm M.S. Angle . Weight of the materials = 3.63Kgs.	Each	137.10
iii)	SSR00567	<b>11KV Special Top Fittings</b> with Clamps (2'.0" Height ) 50x50x6mm M.S. Angle – Weight of the materials = 3.6Kgs.	Each	137.10



i)	SSR00568	<b>LT Top Fittings</b> with Clamps 50x6mm M.S. Flat – Weight of the materials = 2.4 Kgs.	Each	44.50
j)	SSR00569	<b>11KV Tapping Cross arms</b> with (5.6”) 100x50mm M.S. Channel – Weight of the materials =13.4 Kgs	Each	89.10
k)	SSR00570	<b>11KV Tapping Cross arms</b> with (5.6”) 75x40mm M.S. Channel – Weight of the materials = 11.2 Kgs.	Each	140.60
l)	SSR00571	<b>33KV Tapping Cross arms</b> with (7’.0”) 100x50mm M.S. Channel – Weight of the materials = 16.2 Kgs.	Each	94.80
m)	SSR00572	<b>HT/LT Side arms with strut</b>	Each	131.30
		(7’.6”) 75x40mm M.S. Channel		
		(3’.6”) 50x50x6mm M.S. Angle		
		(7’.6”) 50x50x6mm M.S. Angle		
		(3’.0”) 50x50x6mm M.S. Angle – <b>Weight of the materials = 37.600Kgs.</b>		
n)	SSR00573	<b>LT Side arms with strut</b>	Each	190.80
		(5’.6”) 50x50x6mm M.S. Angle		
		(6’.0”) 50x50x6mm M.S. Angle – <b>Weight of the materials = 15.600Kgs.</b>		
o)		<b>M.S Back Clamps (1’.3”)</b>		
i)	SSR00574	With 50x6mm M.S. Flat for 8m/140 Kg Pole – Weight of the materials = 0.84 Kgs.	Each	18.80
ii)	SSR00575	With 50x6mm M.S. Flat for 8m/200 Kg Pole – Weight of the materials = 0.924 Kgs.	Each	18.80
iii)	SSR00576	With 75x8mm M.S. Flat for 9.1m/280 Kg Pole – Weight of the materials = 2.17 Kgs.	Each	19.90
p)		<b>M.S. Stay Clamps (1’.1” X 2Nos.)</b>		
		<b>50x6mm M.S. Flat – Weight of the materials = 1.640Kgs.</b>		
i)	SSR00577	For 8m/140 Kg Pole – Weight of the materials = 1.38 Kgs.	Each	30.50
ii)	SSR00578	For 8m/200 Kg Pole – Weight of the materials = 1.416 Kgs.	Each	31.70
iii)	SSR00579	For 9.1m/280 Kg Pole – Weight of the materials = 3.71 Kgs.	Each	38.70
q)	SSR00580	Pole mounting arrangement for 3.Phase 16/25 KVA DTR’S	Each	288.30
		(4’.0=2Nos.) 75x40mm M.S. Channel		
		(5’.0” =1No) 50x50x6mm M.S. Angle		
		(1’.6”=2Nos.)50x50x6mm M.S. Angle		
		(1’.1”=2Nos.)50x50x6mm M.S. Flat – <b>Weight of the materials = 26Kgs</b>		
r)	SSR00581	<b>D.P. Structures total set</b>	Each set	597.70
		10’ – 2Nos. 100 x 50 MS Channel		
		10’ .2Nos. 50 x 50x 6 Angle		

		3' – 3 Nos. 75 x 40 Channel		
		2' – 4Nos. 50 x 6 MS Flat		
s)		Spun Pole Clamps		
	SSR00582	i) Back Clamps	Each	33.90
	SSR00583	ii) Stay Clamps	Each	28.10
t)	SSR00584	Extension Pieces	Each	173.50
v)	SSR00585	HT/LT Spun Pole mounting	Set	404.10
		8' – 100 x 50 Channel		
		21' – 65 x 65 Angle		
		12' – 75 x 8 MS Flat		
w)	SSR00586	AB Switch OFF & ON Base with Clamp	Set	69.00
58)		<b><u>WELDING CHARGES:.</u></b>		
59)		<b>ARC WELDING</b> charges for all steel materials to a length of 25 mm.(1") of weld including cost of power and electrodes.		
a)	SSR00587	Double welding	25mm	15.20
b)	SSR00588	Single welding	25mm	7.00
60)	SSR00589	<b>GAS WELDING</b> charges for all steel materials to a length of 25 mm.(1") of weld including cost of gas	25mm	12.90
61)	SSR00590	<b>GAS CUTTING</b>	25mm	5.30
62)	SSR00591	Structural Steel erection Charges	1Kg	19.90

#### IV. LOADING AND UN.LOADING CHARGES 2016-17

**(No extra rate towards area allowance is allowed in respect of loading and unloading charges)**

S.No.	Item	Unit	Loading		Un-loading	
			SAP Service code	Rate	SAP Service code	Rate
<b>1)</b>	<b><u>POLES/ SUPPORTS</u></b>					
<b>a)</b>	<b>PSCC POLES</b>					
<b>i)</b>	8m /140 Kg. PscC Poles	EA	SLD00001	91.30	SUD00001	30.60
<b>ii)</b>	8m /200 Kg. PscC Poles	EA	SLD00002	91.30	SUD00002	30.60
<b>iii)</b>	8m /300 Kg. PscC Poles	EA	SLD00003	136.40	SUD00003	44.80
<b>iv)</b>	9.1m /280 Kg. PscC Poles	EA	SLD00004	153.10	SUD00004	44.80
<b>b)</b>	<b>SPUN POLES</b>					
	11m /350 Kg. Spun Poles	EA	SLD00005	333.40	SUD00005	107.90
	12.5m /350 Kg. Spun Poles	EA	SLD00006	393.70	SUD00006	122.20
<b>c)</b>	<b>RS JOISTS /RAIL POLES</b>					
<b>i)</b>	RS Joists 150x150/175x80(10m)	EA	SLD00007	91.30	SUD00007	30.60
<b>ii)</b>	Rail poles 60 lbs (27 feet)	EA	SLD00008	60.50	SUD00008	19.00
<b>iii)</b>	Rail poles 90 lbs. (30 feet)	EA	SLD00009	98.40	SUD00009	30.60
<b>d)</b>	RCC Base Plates	EA	SLD00010	3.60	SUD00010	3.60
<b>2)</b>	<b><u>TRANSFORMERS</u></b>					
<b>a)</b>	<b>Power Transformers</b>					
<b>i)</b>	1.6 MVA PTR	EA	SLD00011	2154.60	SUD00011	2154.60
<b>ii)</b>	3.15 MVA PTR	EA	SLD00012	7024.80	SUD00012	7024.80
<b>iii)</b>	5.0 MVA PTR	EA	SLD00013	8781.30	SUD00013	8781.30
<b>iv)</b>	8.0 MVA PTR	EA	SLD00014	10536.70	SUD00014	10536.70
<b>b)</b>	<b>Distribution Transformers</b>					
<b>i)</b>	1Ph 5KVA DTR	EA	SLD00015	75.90	SUD00015	75.90
<b>ii)</b>	1Ph 15KVA/3Ph 16/25 KVA DTR	EA	SLD00016	167.30	SUD00016	167.30
<b>iii)</b>	DTR's upto 100 KVA	EA	SLD00017	304.00	SUD00017	304.00
<b>iv)</b>	Amorphous make DTRs 100 KVA	EA	SLD00018	379.50	SUD00018	379.50
<b>v)</b>	160KVA DTR	EA	SLD00019	456.70	SUD00019	456.70
<b>vi)</b>	DTRs from 250 KVA to 315 KVA	EA	SLD00020	760.10	SUD00020	760.10
<b>vii)</b>	33 KV P.T. (or) C.T.	EA	SLD00021	167.30	SUD00021	167.30
<b>viii)</b>	11 KV P.T. (or) C.T.	EA	SLD00022	84.20	SUD00022	84.20
<b>c)</b>	<b>Isolators</b>					
<b>i)</b>	33 KV AB switch	EA	SLD00023	71.10	SUD00023	71.10
<b>ii)</b>	11 KV AB switch	EA	SLD00024	36.70	SUD00024	36.70

iii)	11 KV H.G. Fuse set	EA	SLD00025	9.50	SUD00025	9.50
iv)	L.T. H.G. Fuse set	EA	SLD00026	7.70	SUD00026	7.70
3)	<b><u>EQUIPMENT</u></b>					
a)	33 KV VCB	SET	SLD00027	1214.00	SUD00027	1214.00
b)	11 KV VCB	SET	SLD00028	1000.70	SUD00028	1000.70
c)	11 KV control panels	EA	SLD00029	136.70	SUD00029	136.70
d)	11 KV Metering cubicle	SET	SLD00030	181.60	SUD00030	181.60
e)	Batteries	EA	SLD00031	3.60	SUD00031	3.60
f)	Trickal Chargers with batteries	EA	SLD00032	30.60	SUD00032	30.60
4)	<b><u>IRON MATERIALS</u></b>					
a)	Iron and steel materials	TO	SLD00033	272.30	SUD00033	272.30
b)	H.T, Mild steel wire	TO	SLD00034	272.30	SUD00034	272.30
c)	Stay wire, G.I wire	TO	SLD00035	272.30	SUD00035	272.30
d)	D.P. structural materials	SET	SLD00036	30.60	SUD00036	30.60
e)	33 KV ' V' cross arms	EA	SLD00037	5.60	SUD00037	5.60
f)	11 KV ' V' cross arms	EA	SLD00038	5.40	SUD00038	5.40
g)	Three phase cross arms	EA	SLD00039	1.90	SUD00039	1.90
h)	Single phase cross.arms	EA	SLD00040	1.30	SUD00040	1.30
i)	33 KV Top Fittings	EA	SLD00041	3.10	SUD00041	3.10
j)	11 KV Top Fittings	EA	SLD00042	2.50	SUD00042	2.50
k)	L.T Top Fittings	EA	SLD00043	1.30	SUD00043	1.30
l)	Back clamps	EA	SLD00044	1.30	SUD00044	1.30
m)	Stay clamps set	SET	SLD00045	1.30	SUD00045	1.30
n)	Stay set	SET	SLD00046	5.00	SUD00046	5.00
o)	G.I. Earth pipes	EA	SLD00047	2.40	SUD00047	2.50
p)	C.I. Earth pipes	EA	SLD00048	9.50	SUD00048	9.50
q)	'A' Type Distribution Box	EA	SLD00049	7.40	SUD00049	7.40
r)	'B' type distribution box	SET	SLD00050	3.10	SUD00050	3.10
5)	M.S/GI Bolts & Nuts	KG	SLD00051	0.70	SUD00051	0.70
6)	<b><u>INSULATORS &amp; PINS</u></b>					
a)	<b>33KV</b>					
i)	33 KV Post type Insulators					
(1)	2 piece type	EA	SLD00052	1.30	SUD00052	1.30
(2)	Single piece solid core type	EA	SLD00053	2.00	SUD00053	2.00
ii)	33 KV Pin Insulators	EA	SLD00054	1.70	SUD00054	1.70
iii)	33 KV G.I. Pins	EA	SLD00055	0.80	SUD00055	0.80
iv)	33 KV Polymer disc	EA	SLD00056	0.80	SUD00056	0.80
v)	33 KV LAS	EA	SLD00057	29.60	SUD00057	29.60
b)	<b>11KV</b>					

<b>i)</b>	11 KV Post type Insulators	EA	SLD00058	1.30	SUD00058	1.30
<b>ii)</b>	11 KV Pin Insulators	EA	SLD00059	1.30	SUD00059	1.30
<b>iii)</b>	11 KV GI Pins	EA	SLD00060	0.90	SUD00060	0.90
<b>iv)</b>	11 KV Disc Insulators	EA	SLD00061	1.30	SUD00061	1.30
<b>v)</b>	11 KV Polymer disc	EA	SLD00062	0.90	SUD00062	0.90
<b>vi)</b>	11 KV/33KV Metal parts	SET	SLD00063	0.90	SUD00063	0.90
<b>vii)</b>	H.T. Guy Insulators	EA	SLD00064	1.00	SUD00064	1.00
<b>viii)</b>	11 KV LAS					
<b>(1)</b>	11 KV LAS(Station Type)	EA	SLD00065	15.40	SUD00065	15.40
<b>(2)</b>	11 KV LAS(Line Type)	EA	SLD00066	3.10	SUD00066	3.10
<b>c)</b>	LT					
<b>i)</b>	L.T. Pin Insulators	EA	SLD00067	0.80	SUD00067	0.80
<b>ii)</b>	L.T.G.I. Pins	SET	SLD00068	0.80	SUD00068	0.80
<b>iii)</b>	L.T. Shackles	EA	SLD00069	0.90	SUD00069	0.90
<b>iv)</b>	L.T. metal parts	SET	SLD00070	0.80	SUD00070	0.80
<b>v)</b>	L.T. Guy Insulators	EA	SLD00071	0.90	SUD00071	0.90
<b>7)</b>	<u>CONDUCTOR/ CABLE</u>					
<b>a)</b>	Conductor Drum(All)	EA	SLD00072	304.00	SUD00072	304.00
<b>b)</b>	PVC Cable(>25 upto 185sq.mm)	TO	SLD00073	272.30	SUD00073	272.30
<b>c)</b>	PVC Cable upto and 10 Sq. mm	ROL	SLD00074	2.00	SUD00074	2.00
<b>d)</b>	<b>Un coiling of cables/ conductors</b>					
<b>i)</b>	Un-coiling conductor from MainDrum & Ldg	KM			SWR20072	75.50
<b>ii)</b>	Un-coiling PVC / Ctrlcable 25 to 185 Sqmm-100RM	EA			SWR20073	60.20
<b>iii)</b>	Un-coiling XLPE Power Cable	M			SWR20074	10.90
<b>iv)</b>	Un-coiling of panther conductor- 100RM	EA			SWR20075	80.90
<b>8)</b>	<b><u>GENERAL ITEMS</u></b>					
<b>a)</b>	Transformer oil drums with oil	EA	SLD00075	45.10	SUD00075	45.10
<b>b)</b>	Empty oil drums	EA	SLD00076	3.10	SUD00076	3.10
<b>c)</b>	C.T. Meters	EA	SLD00077	9.40	SUD00077	9.40
<b>d)</b>	3Ph/CT Meter Boxes	EA	SLD00078	3.10	SUD00078	3.10
<b>e)</b>	3Ph Meters	EA	SLD00079	2.50	SUD00079	2.50
<b>f)</b>	1Ph Meters	EA	SLD00080	1.50	SUD00080	1.50
<b>g)</b>	Pilfer proof box	SET	SLD00081	1.20	SUD00081	1.20
<b>h)</b>	Fuse units 16 A to 32 A	EA	SLD00082	0.80	SUD00082	0.80
<b>i)</b>	Fuse units 63 A / 100 A	EA	SLD00083	0.70	SUD00083	0.70
<b>j)</b>	Fuse units 200 A, 300 A	EA	SLD00084	0.90	SUD00084	0.90
<b>k)</b>	Lugs	CAR	SLD00085	1.00	SUD00085	1.00

<b>l)</b>	Male / Female Contacts	BAG	SLD00086	15.40	SUD00086	15.40
<b>m)</b>	Cable Jointing kits	EA	SLD00087	1.60	SUD00087	1.60
<b>n)</b>	Street light fixture	SET	SLD00088	1.10	SUD00088	1.10
<b>o)</b>	Fuse wire/MRT Materials	KG	SLD00089	1.50	SUD00089	1.50
<b>p)</b>	Winding wire up to 5 Kg	ROL	SLD00090	4.00	SUD00090	4.00
<b>q)</b>	Winding wire more than 5 Kg	ROL	SLD00091	9.40	SUD00091	9.40
<b>r)</b>	<b>Paints</b>					
<b>i)</b>	Paints upto & including 5 Lts	EA	SLD00092	1.60	SUD00092	1.60
<b>ii)</b>	Paints >5 Lts<=20 lts	EA	SLD00093	6.30	SUD00093	6.30
<b>s)</b>	Cement	TO	SLD00094	122.20	SUD00094	122.20
<b>t)</b>	<b>Loading and unloading of any other materials</b>					
<b>i)</b>	Indoor Items upto 10 Kgs	BAG	SLD00095	9.40	SUD00095	9.40
<b>ii)</b>	Indoor Items > 10 Kgs	BAG	SLD00096	15.40	SUD00096	15.40
<b>iii)</b>	11KV200A TT Type ABSwitch M.A	EA	SLD00097	10.00	SUD00097	10.00
<b>iv)</b>	40 KVA DTR mounting arrangements	EA	SLD00098	20.70	SUD00098	20.70
<b>v)</b>	33KV HV/LV twin feeder panel	EA	SLD00099	143.30	SUD00099	143.30
<b>9)</b>	<b>SCRAP</b>					
<b>a)</b>	Al./Cu/Plastic Scrap	TO	SLD00100	605.90	SUD00100	605.90
<b>b)</b>	Meters Scrap W/weightment	TO	SLD00101	605.90	SUD00101	605.90
<b>c)</b>	MS/Lead Scrap W/weightment	TO	SLD00102	456.70	SUD00102	456.70
<b>10)</b>	Seating arrangements of 3ph 16/25KVA DTRs	EA	SWR20033	15.00	SWR20134	15.00

## **TRANSPORT CHARGES**

### **1. Transport of Cement:-**

<b>Sl No</b>	<b>Lead in KM</b>	<b>Transport charges of Cement per MT</b>
1	Up to and including 5.0Km	Rs.222.00Ps
2	5.0Km to 500 Km	Rs.222.00Ps +Rs.5.70 Ps per Km above5.0Km
3	Beyond 500 Km	Rs.3.70 Ps per Km above

**New items**

<b>Sl No.</b>	<b>SAP Service code</b>	<b>Description</b>	<b>Unit</b>	<b>Rate</b>
1)		Dismantling of Cement Concrete and disposable of 100mtrs lead including hire charges of T&p, all operational incidental and labour charges complete	<b>1 Cum</b>	862.60
2)		Labour charges for fabricating all heavy steel structures like M+3, M+6, M+9 towers , Trusses, including cost of welding rods, power charges, etc excluding cost of fixing in position	<b>1 Kg</b>	21.00
3)		Labour charges for erection / fixing of heavy steel structures, like M+3, M+6, M+9 towers , Trusses erecting in position and fixing by using chain pulley blocks, Derek pole arrangements and cranes etc., complete in position	<b>1 Kg</b>	19.00
4)		Providing of trenchless digging with HDD (Horizontal Directional Drilling) method for laying & installation of HT or LT lines using XLPE UG Cables with out disturbing the upper soil crest with the help of trenchless HDD machine having capacity more than 10 Tonne pull back with 8" reamer and should be able to bore up to 200Mts in single stretch to a depth of 1.65 Mts to 3Mts, duly making man hole (Trail Pit) for pilot as per field requirement for placing the HDD machine, barricading arrangements route markers, hire charges of HDD machine and other T&P, all operational & incidental charges, labour charges etc., complete for finished item of work.	<b>RM</b>	3500.00

**2. Transport of steel materials ( including ribbed rod, HT steel wire, channels, angles, RS joists, rail poles, fabricated materials) and lubricating oil:-**

(These rates are excluding the loading, un-loading & stacking charges).

SAP Service code	Lead in KM	Rate/MT	SAP Service code	Lead in KM	Rate/MT	SAP Service code	Lead in KM	Rate/MT	SAP Service code	Lead in KM	Rate/MT
STRS0001	1.0 KM	258.00	STRS0176	176.0 KM	1697.00	STRS0351	351.0 KM	2932.00	STRS0526	526.0 KM	4167.00
STRS0002	2.0 KM	267.00	STRS0177	177.0 KM	1704.00	STRS0352	352.0 KM	2939.00	STRS0527	527.0 KM	4174.00
STRS0003	3.0 KM	279.00	STRS0178	178.0 KM	1711.00	STRS0353	353.0 KM	2946.00	STRS0528	528.0 KM	4181.00
STRS0004	4.0 KM	290.00	STRS0179	179.0 KM	1718.00	STRS0354	354.0 KM	2953.00	STRS0529	529.0 KM	4188.00
STRS0005	5.0 KM	299.00	STRS0180	180.0 KM	1726.00	STRS0355	355.0 KM	2960.00	STRS0530	530.0 KM	4195.00
STRS0006	6.0 KM	325.00	STRS0181	181.0 KM	1733.00	STRS0356	356.0 KM	2967.00	STRS0531	531.0 KM	4202.00
STRS0007	7.0 KM	334.00	STRS0182	182.0 KM	1740.00	STRS0357	357.0 KM	2974.00	STRS0532	532.0 KM	4209.00
STRS0008	8.0 KM	346.00	STRS0183	183.0 KM	1747.00	STRS0358	358.0 KM	2982.00	STRS0533	533.0 KM	4216.00
STRS0009	9.0 KM	356.00	STRS0184	184.0 KM	1754.00	STRS0359	359.0 KM	2989.00	STRS0534	534.0 KM	4223.00
STRS0010	10.0 KM	368.00	STRS0185	185.0 KM	1761.00	STRS0360	360.0 KM	2996.00	STRS0535	535.0 KM	4230.00
STRS0011	11.0 KM	380.00	STRS0186	186.0 KM	1768.00	STRS0361	361.0 KM	3003.00	STRS0536	536.0 KM	4237.00
STRS0012	12.0 KM	389.00	STRS0187	187.0 KM	1775.00	STRS0362	362.0 KM	3010.00	STRS0537	537.0 KM	4245.00
STRS0013	13.0 KM	401.00	STRS0188	188.0 KM	1782.00	STRS0363	363.0 KM	3017.00	STRS0538	538.0 KM	4252.00
STRS0014	14.0 KM	411.00	STRS0189	189.0 KM	1789.00	STRS0364	364.0 KM	3024.00	STRS0539	539.0 KM	4259.00
STRS0015	15.0 KM	422.00	STRS0190	190.0 KM	1796.00	STRS0365	365.0 KM	3031.00	STRS0540	540.0 KM	4266.00
STRS0016	16.0 KM	431.00	STRS0191	191.0 KM	1803.00	STRS0366	366.0 KM	3038.00	STRS0541	541.0 KM	4273.00
STRS0017	17.0 KM	440.00	STRS0192	192.0 KM	1810.00	STRS0367	367.0 KM	3045.00	STRS0542	542.0 KM	4280.00
STRS0018	18.0 KM	452.00	STRS0193	193.0 KM	1817.00	STRS0368	368.0 KM	3052.00	STRS0543	543.0 KM	4287.00
STRS0019	19.0 KM	463.00	STRS0194	194.0 KM	1824.00	STRS0369	369.0 KM	3059.00	STRS0544	544.0 KM	4294.00
STRS0020	20.0 KM	477.00	STRS0195	195.0 KM	1831.00	STRS0370	370.0 KM	3066.00	STRS0545	545.0 KM	4301.00
STRS0021	21.0 KM	488.00	STRS0196	196.0 KM	1838.00	STRS0371	371.0 KM	3073.00	STRS0546	546.0 KM	4308.00
STRS0022	22.0 KM	498.00	STRS0197	197.0 KM	1845.00	STRS0372	372.0 KM	3080.00	STRS0547	547.0 KM	4315.00
STRS0023	23.0 KM	509.00	STRS0198	198.0 KM	1853.00	STRS0373	373.0 KM	3087.00	STRS0548	548.0 KM	4322.00
STRS0024	24.0 KM	520.00	STRS0199	199.0 KM	1860.00	STRS0374	374.0 KM	3094.00	STRS0549	549.0 KM	4329.00
STRS0025	25.0 KM	530.00	STRS0200	200.0 KM	1867.00	STRS0375	375.0 KM	3101.00	STRS0550	550.0 KM	4336.00
STRS0026	26.0 KM	541.00	STRS0201	201.0 KM	1874.00	STRS0376	376.0 KM	3109.00	STRS0551	551.0 KM	4343.00
STRS0027	27.0 KM	552.00	STRS0202	202.0 KM	1881.00	STRS0377	377.0 KM	3116.00	STRS0552	552.0 KM	4350.00



SAP Service code	Lead in KM	Rate/MT	SAP Service code	Lead in KM	Rate/MT	SAP Service code	Lead in KM	Rate/MT	SAP Service code	Lead in KM	Rate/MT
STRS0028	28.0 KM	562.00	STRS0203	203.0 KM	1888.00	STRS0378	378.0 KM	3123.00	STRS0553	553.0 KM	4357.00
STRS0029	29.0 KM	573.00	STRS0204	204.0 KM	1895.00	STRS0379	379.0 KM	3130.00	STRS0554	554.0 KM	4364.00
STRS0030	30.0 KM	584.00	STRS0205	205.0 KM	1902.00	STRS0380	380.0 KM	3137.00	STRS0555	555.0 KM	4372.00
STRS0031	31.0 KM	592.00	STRS0206	206.0 KM	1909.00	STRS0381	381.0 KM	3144.00	STRS0556	556.0 KM	4379.00
STRS0032	32.0 KM	601.00	STRS0207	207.0 KM	1916.00	STRS0382	382.0 KM	3151.00	STRS0557	557.0 KM	4386.00
STRS0033	33.0 KM	609.00	STRS0208	208.0 KM	1923.00	STRS0383	383.0 KM	3158.00	STRS0558	558.0 KM	4393.00
STRS0034	34.0 KM	618.00	STRS0209	209.0 KM	1930.00	STRS0384	384.0 KM	3165.00	STRS0559	559.0 KM	4400.00
STRS0035	35.0 KM	626.00	STRS0210	210.0 KM	1937.00	STRS0385	385.0 KM	3172.00	STRS0560	560.0 KM	4407.00
STRS0036	36.0 KM	635.00	STRS0211	211.0 KM	1944.00	STRS0386	386.0 KM	3179.00	STRS0561	561.0 KM	4414.00
STRS0037	37.0 KM	644.00	STRS0212	212.0 KM	1951.00	STRS0387	387.0 KM	3186.00	STRS0562	562.0 KM	4421.00
STRS0038	38.0 KM	652.00	STRS0213	213.0 KM	1958.00	STRS0388	388.0 KM	3193.00	STRS0563	563.0 KM	4428.00
STRS0039	39.0 KM	661.00	STRS0214	214.0 KM	1965.00	STRS0389	389.0 KM	3200.00	STRS0564	564.0 KM	4435.00
STRS0040	40.0 KM	669.00	STRS0215	215.0 KM	1972.00	STRS0390	390.0 KM	3207.00	STRS0565	565.0 KM	4442.00
STRS0041	41.0 KM	678.00	STRS0216	216.0 KM	1980.00	STRS0391	391.0 KM	3214.00	STRS0566	566.0 KM	4449.00
STRS0042	42.0 KM	686.00	STRS0217	217.0 KM	1987.00	STRS0392	392.0 KM	3221.00	STRS0567	567.0 KM	4456.00
STRS0043	43.0 KM	695.00	STRS0218	218.0 KM	1994.00	STRS0393	393.0 KM	3228.00	STRS0568	568.0 KM	4463.00
STRS0044	44.0 KM	703.00	STRS0219	219.0 KM	2001.00	STRS0394	394.0 KM	3236.00	STRS0569	569.0 KM	4470.00
STRS0045	45.0 KM	712.00	STRS0220	220.0 KM	2008.00	STRS0395	395.0 KM	3243.00	STRS0570	570.0 KM	4477.00
STRS0046	46.0 KM	721.00	STRS0221	221.0 KM	2015.00	STRS0396	396.0 KM	3250.00	STRS0571	571.0 KM	4484.00
STRS0047	47.0 KM	729.00	STRS0222	222.0 KM	2022.00	STRS0397	397.0 KM	3257.00	STRS0572	572.0 KM	4492.00
STRS0048	48.0 KM	738.00	STRS0223	223.0 KM	2029.00	STRS0398	398.0 KM	3264.00	STRS0573	573.0 KM	4499.00
STRS0049	49.0 KM	746.00	STRS0224	224.0 KM	2036.00	STRS0399	399.0 KM	3271.00	STRS0574	574.0 KM	4506.00
STRS0050	50.0 KM	755.00	STRS0225	225.0 KM	2043.00	STRS0400	400.0 KM	3278.00	STRS0575	575.0 KM	4513.00
STRS0051	51.0 KM	763.00	STRS0226	226.0 KM	2050.00	STRS0401	401.0 KM	3285.00	STRS0576	576.0 KM	4520.00
STRS0052	52.0 KM	772.00	STRS0227	227.0 KM	2057.00	STRS0402	402.0 KM	3292.00	STRS0577	577.0 KM	4527.00
STRS0053	53.0 KM	780.00	STRS0228	228.0 KM	2064.00	STRS0403	403.0 KM	3299.00	STRS0578	578.0 KM	4534.00
STRS0054	54.0 KM	789.00	STRS0229	229.0 KM	2071.00	STRS0404	404.0 KM	3306.00	STRS0579	579.0 KM	4541.00
STRS0055	55.0 KM	798.00	STRS0230	230.0 KM	2078.00	STRS0405	405.0 KM	3313.00	STRS0580	580.0 KM	4548.00
STRS0056	56.0 KM	806.00	STRS0231	231.0 KM	2085.00	STRS0406	406.0 KM	3320.00	STRS0581	581.0 KM	4555.00
STRS0057	57.0 KM	815.00	STRS0232	232.0 KM	2092.00	STRS0407	407.0 KM	3327.00	STRS0582	582.0 KM	4562.00
STRS0058	58.0 KM	823.00	STRS0233	233.0 KM	2099.00	STRS0408	408.0 KM	3334.00	STRS0583	583.0 KM	4569.00
STRS0059	59.0 KM	832.00	STRS0234	234.0 KM	2107.00	STRS0409	409.0 KM	3341.00	STRS0584	584.0 KM	4576.00
STRS0060	60.0 KM	840.00	STRS0235	235.0 KM	2114.00	STRS0410	410.0 KM	3348.00	STRS0585	585.0 KM	4583.00

SAP Service code	Lead in KM	Rate/MT	SAP Service code	Lead in KM	Rate/MT	SAP Service code	Lead in KM	Rate/MT	SAP Service code	Lead in KM	Rate/MT
STRS0061	61.0 KM	849.00	STRS0236	236.0 KM	2121.00	STRS0411	411.0 KM	3355.00	STRS0586	586.0 KM	4590.00
STRS0062	62.0 KM	857.00	STRS0237	237.0 KM	2128.00	STRS0412	412.0 KM	3363.00	STRS0587	587.0 KM	4597.00
STRS0063	63.0 KM	866.00	STRS0238	238.0 KM	2135.00	STRS0413	413.0 KM	3370.00	STRS0588	588.0 KM	4604.00
STRS0064	64.0 KM	875.00	STRS0239	239.0 KM	2142.00	STRS0414	414.0 KM	3377.00	STRS0589	589.0 KM	4611.00
STRS0065	65.0 KM	883.00	STRS0240	240.0 KM	2149.00	STRS0415	415.0 KM	3384.00	STRS0590	590.0 KM	4619.00
STRS0066	66.0 KM	892.00	STRS0241	241.0 KM	2156.00	STRS0416	416.0 KM	3391.00	STRS0591	591.0 KM	4626.00
STRS0067	67.0 KM	900.00	STRS0242	242.0 KM	2163.00	STRS0417	417.0 KM	3398.00	STRS0592	592.0 KM	4633.00
STRS0068	68.0 KM	909.00	STRS0243	243.0 KM	2170.00	STRS0418	418.0 KM	3405.00	STRS0593	593.0 KM	4640.00
STRS0069	69.0 KM	917.00	STRS0244	244.0 KM	2177.00	STRS0419	419.0 KM	3412.00	STRS0594	594.0 KM	4647.00
STRS0070	70.0 KM	926.00	STRS0245	245.0 KM	2184.00	STRS0420	420.0 KM	3419.00	STRS0595	595.0 KM	4654.00
STRS0071	71.0 KM	934.00	STRS0246	246.0 KM	2191.00	STRS0421	421.0 KM	3426.00	STRS0596	596.0 KM	4661.00
STRS0072	72.0 KM	943.00	STRS0247	247.0 KM	2198.00	STRS0422	422.0 KM	3433.00	STRS0597	597.0 KM	4668.00
STRS0073	73.0 KM	951.00	STRS0248	248.0 KM	2205.00	STRS0423	423.0 KM	3440.00	STRS0598	598.0 KM	4675.00
STRS0074	74.0 KM	960.00	STRS0249	249.0 KM	2212.00	STRS0424	424.0 KM	3447.00	STRS0599	599.0 KM	4682.00
STRS0075	75.0 KM	969.00	STRS0250	250.0 KM	2219.00	STRS0425	425.0 KM	3454.00	STRS0600	600.0 KM	4689.00
STRS0076	76.0 KM	977.00	STRS0251	251.0 KM	2227.00	STRS0426	426.0 KM	3461.00	STRS0601	601.0 KM	4696.00
STRS0077	77.0 KM	986.00	STRS0252	252.0 KM	2234.00	STRS0427	427.0 KM	3468.00	STRS0602	602.0 KM	4703.00
STRS0078	78.0 KM	994.00	STRS0253	253.0 KM	2241.00	STRS0428	428.0 KM	3475.00	STRS0603	603.0 KM	4710.00
STRS0079	79.0 KM	1003.00	STRS0254	254.0 KM	2248.00	STRS0429	429.0 KM	3482.00	STRS0604	604.0 KM	4717.00
STRS0080	80.0 KM	1011.00	STRS0255	255.0 KM	2255.00	STRS0430	430.0 KM	3490.00	STRS0605	605.0 KM	4724.00
STRS0081	81.0 KM	1019.00	STRS0256	256.0 KM	2262.00	STRS0431	431.0 KM	3497.00	STRS0606	606.0 KM	4731.00
STRS0082	82.0 KM	1026.00	STRS0257	257.0 KM	2269.00	STRS0432	432.0 KM	3504.00	STRS0607	607.0 KM	4738.00
STRS0083	83.0 KM	1034.00	STRS0258	258.0 KM	2276.00	STRS0433	433.0 KM	3511.00	STRS0608	608.0 KM	4746.00
STRS0084	84.0 KM	1041.00	STRS0259	259.0 KM	2283.00	STRS0434	434.0 KM	3518.00	STRS0609	609.0 KM	4753.00
STRS0085	85.0 KM	1049.00	STRS0260	260.0 KM	2290.00	STRS0435	435.0 KM	3525.00	STRS0610	610.0 KM	4760.00
STRS0086	86.0 KM	1056.00	STRS0261	261.0 KM	2297.00	STRS0436	436.0 KM	3532.00	STRS0611	611.0 KM	4767.00
STRS0087	87.0 KM	1064.00	STRS0262	262.0 KM	2304.00	STRS0437	437.0 KM	3539.00	STRS0612	612.0 KM	4774.00
STRS0088	88.0 KM	1071.00	STRS0263	263.0 KM	2311.00	STRS0438	438.0 KM	3546.00	STRS0613	613.0 KM	4781.00
STRS0089	89.0 KM	1079.00	STRS0264	264.0 KM	2318.00	STRS0439	439.0 KM	3553.00	STRS0614	614.0 KM	4788.00
STRS0090	90.0 KM	1086.00	STRS0265	265.0 KM	2325.00	STRS0440	440.0 KM	3560.00	STRS0615	615.0 KM	4795.00
STRS0091	91.0 KM	1094.00	STRS0266	266.0 KM	2332.00	STRS0441	441.0 KM	3567.00	STRS0616	616.0 KM	4802.00
STRS0092	92.0 KM	1101.00	STRS0267	267.0 KM	2339.00	STRS0442	442.0 KM	3574.00	STRS0617	617.0 KM	4809.00
STRS0093	93.0 KM	1109.00	STRS0268	268.0 KM	2346.00	STRS0443	443.0 KM	3581.00	STRS0618	618.0 KM	4816.00

SAP Service code	Lead in KM	Rate/MT	SAP Service code	Lead in KM	Rate/MT	SAP Service code	Lead in KM	Rate/MT	SAP Service code	Lead in KM	Rate/MT
STRS0094	94.0 KM	1116.00	STRS0269	269.0 KM	2354.00	STRS0444	444.0 KM	3588.00	STRS0619	619.0 KM	4823.00
STRS0095	95.0 KM	1124.00	STRS0270	270.0 KM	2361.00	STRS0445	445.0 KM	3595.00	STRS0620	620.0 KM	4830.00
STRS0096	96.0 KM	1131.00	STRS0271	271.0 KM	2368.00	STRS0446	446.0 KM	3602.00	STRS0621	621.0 KM	4837.00
STRS0097	97.0 KM	1139.00	STRS0272	272.0 KM	2375.00	STRS0447	447.0 KM	3609.00	STRS0622	622.0 KM	4844.00
STRS0098	98.0 KM	1146.00	STRS0273	273.0 KM	2382.00	STRS0448	448.0 KM	3617.00	STRS0623	623.0 KM	4851.00
STRS0099	99.0 KM	1154.00	STRS0274	274.0 KM	2389.00	STRS0449	449.0 KM	3624.00	STRS0624	624.0 KM	4858.00
STRS0100	100.0 KM	1161.00	STRS0275	275.0 KM	2396.00	STRS0450	450.0 KM	3631.00	STRS0625	625.0 KM	4865.00
STRS0101	101.0 KM	1168.00	STRS0276	276.0 KM	2403.00	STRS0451	451.0 KM	3638.00	STRS0626	626.0 KM	4873.00
STRS0102	102.0 KM	1175.00	STRS0277	277.0 KM	2410.00	STRS0452	452.0 KM	3645.00	STRS0627	627.0 KM	4880.00
STRS0103	103.0 KM	1182.00	STRS0278	278.0 KM	2417.00	STRS0453	453.0 KM	3652.00	STRS0628	628.0 KM	4887.00
STRS0104	104.0 KM	1189.00	STRS0279	279.0 KM	2424.00	STRS0454	454.0 KM	3659.00	STRS0629	629.0 KM	4894.00
STRS0105	105.0 KM	1196.00	STRS0280	280.0 KM	2431.00	STRS0455	455.0 KM	3666.00	STRS0630	630.0 KM	4901.00
STRS0106	106.0 KM	1203.00	STRS0281	281.0 KM	2438.00	STRS0456	456.0 KM	3673.00	STRS0631	631.0 KM	4908.00
STRS0107	107.0 KM	1210.00	STRS0282	282.0 KM	2445.00	STRS0457	457.0 KM	3680.00	STRS0632	632.0 KM	4915.00
STRS0108	108.0 KM	1217.00	STRS0283	283.0 KM	2452.00	STRS0458	458.0 KM	3687.00	STRS0633	633.0 KM	4922.00
STRS0109	109.0 KM	1225.00	STRS0284	284.0 KM	2459.00	STRS0459	459.0 KM	3694.00	STRS0634	634.0 KM	4929.00
STRS0110	110.0 KM	1232.00	STRS0285	285.0 KM	2466.00	STRS0460	460.0 KM	3701.00	STRS0635	635.0 KM	4936.00
STRS0111	111.0 KM	1239.00	STRS0286	286.0 KM	2473.00	STRS0461	461.0 KM	3708.00	STRS0636	636.0 KM	4943.00
STRS0112	112.0 KM	1246.00	STRS0287	287.0 KM	2481.00	STRS0462	462.0 KM	3715.00	STRS0637	637.0 KM	4950.00
STRS0113	113.0 KM	1253.00	STRS0288	288.0 KM	2488.00	STRS0463	463.0 KM	3722.00	STRS0638	638.0 KM	4957.00
STRS0114	114.0 KM	1260.00	STRS0289	289.0 KM	2495.00	STRS0464	464.0 KM	3729.00	STRS0639	639.0 KM	4964.00
STRS0115	115.0 KM	1267.00	STRS0290	290.0 KM	2502.00	STRS0465	465.0 KM	3737.00	STRS0640	640.0 KM	4971.00
STRS0116	116.0 KM	1274.00	STRS0291	291.0 KM	2509.00	STRS0466	466.0 KM	3744.00	STRS0641	641.0 KM	4978.00
STRS0117	117.0 KM	1281.00	STRS0292	292.0 KM	2516.00	STRS0467	467.0 KM	3751.00	STRS0642	642.0 KM	4985.00
STRS0118	118.0 KM	1288.00	STRS0293	293.0 KM	2523.00	STRS0468	468.0 KM	3758.00	STRS0643	643.0 KM	4992.00
STRS0119	119.0 KM	1295.00	STRS0294	294.0 KM	2530.00	STRS0469	469.0 KM	3765.00	STRS0644	644.0 KM	5000.00
STRS0120	120.0 KM	1302.00	STRS0295	295.0 KM	2537.00	STRS0470	470.0 KM	3772.00	STRS0645	645.0 KM	5007.00
STRS0121	121.0 KM	1309.00	STRS0296	296.0 KM	2544.00	STRS0471	471.0 KM	3779.00	STRS0646	646.0 KM	5014.00
STRS0122	122.0 KM	1316.00	STRS0297	297.0 KM	2551.00	STRS0472	472.0 KM	3786.00	STRS0647	647.0 KM	5021.00
STRS0123	123.0 KM	1323.00	STRS0298	298.0 KM	2558.00	STRS0473	473.0 KM	3793.00	STRS0648	648.0 KM	5028.00
STRS0124	124.0 KM	1330.00	STRS0299	299.0 KM	2565.00	STRS0474	474.0 KM	3800.00	STRS0649	649.0 KM	5035.00
STRS0125	125.0 KM	1337.00	STRS0300	300.0 KM	2572.00	STRS0475	475.0 KM	3807.00	STRS0650	650.0 KM	5042.00
STRS0126	126.0 KM	1345.00	STRS0301	301.0 KM	2579.00	STRS0476	476.0 KM	3814.00	STRS0651	651.0 KM	5049.00

SAP Service code	Lead in KM	Rate/MT	SAP Service code	Lead in KM	Rate/MT	SAP Service code	Lead in KM	Rate/MT	SAP Service code	Lead in KM	Rate/MT
STRS0127	127.0 KM	1352.00	STRS0302	302.0 KM	2586.00	STRS0477	477.0 KM	3821.00	STRS0652	652.0 KM	5056.00
STRS0128	128.0 KM	1359.00	STRS0303	303.0 KM	2593.00	STRS0478	478.0 KM	3828.00	STRS0653	653.0 KM	5063.00
STRS0129	129.0 KM	1366.00	STRS0304	304.0 KM	2600.00	STRS0479	479.0 KM	3835.00	STRS0654	654.0 KM	5070.00
STRS0130	130.0 KM	1373.00	STRS0305	305.0 KM	2608.00	STRS0480	480.0 KM	3842.00	STRS0655	655.0 KM	5077.00
STRS0131	131.0 KM	1380.00	STRS0306	306.0 KM	2615.00	STRS0481	481.0 KM	3849.00	STRS0656	656.0 KM	5084.00
STRS0132	132.0 KM	1387.00	STRS0307	307.0 KM	2622.00	STRS0482	482.0 KM	3856.00	STRS0657	657.0 KM	5091.00
STRS0133	133.0 KM	1394.00	STRS0308	308.0 KM	2629.00	STRS0483	483.0 KM	3864.00	STRS0658	658.0 KM	5098.00
STRS0134	134.0 KM	1401.00	STRS0309	309.0 KM	2636.00	STRS0484	484.0 KM	3871.00	STRS0659	659.0 KM	5105.00
STRS0135	135.0 KM	1408.00	STRS0310	310.0 KM	2643.00	STRS0485	485.0 KM	3878.00	STRS0660	660.0 KM	5112.00
STRS0136	136.0 KM	1415.00	STRS0311	311.0 KM	2650.00	STRS0486	486.0 KM	3885.00	STRS0661	661.0 KM	5119.00
STRS0137	137.0 KM	1422.00	STRS0312	312.0 KM	2657.00	STRS0487	487.0 KM	3892.00	STRS0662	662.0 KM	5127.00
STRS0138	138.0 KM	1429.00	STRS0313	313.0 KM	2664.00	STRS0488	488.0 KM	3899.00	STRS0663	663.0 KM	5134.00
STRS0139	139.0 KM	1436.00	STRS0314	314.0 KM	2671.00	STRS0489	489.0 KM	3906.00	STRS0664	664.0 KM	5141.00
STRS0140	140.0 KM	1443.00	STRS0315	315.0 KM	2678.00	STRS0490	490.0 KM	3913.00	STRS0665	665.0 KM	5148.00
STRS0141	141.0 KM	1450.00	STRS0316	316.0 KM	2685.00	STRS0491	491.0 KM	3920.00	STRS0666	666.0 KM	5155.00
STRS0142	142.0 KM	1457.00	STRS0317	317.0 KM	2692.00	STRS0492	492.0 KM	3927.00	STRS0667	667.0 KM	5162.00
STRS0143	143.0 KM	1464.00	STRS0318	318.0 KM	2699.00	STRS0493	493.0 KM	3934.00	STRS0668	668.0 KM	5169.00
STRS0144	144.0 KM	1472.00	STRS0319	319.0 KM	2706.00	STRS0494	494.0 KM	3941.00	STRS0669	669.0 KM	5176.00
STRS0145	145.0 KM	1479.00	STRS0320	320.0 KM	2713.00	STRS0495	495.0 KM	3948.00	STRS0670	670.0 KM	5183.00
STRS0146	146.0 KM	1486.00	STRS0321	321.0 KM	2720.00	STRS0496	496.0 KM	3955.00	STRS0671	671.0 KM	5190.00
STRS0147	147.0 KM	1493.00	STRS0322	322.0 KM	2727.00	STRS0497	497.0 KM	3962.00	STRS0672	672.0 KM	5197.00
STRS0148	148.0 KM	1500.00	STRS0323	323.0 KM	2735.00	STRS0498	498.0 KM	3969.00	STRS0673	673.0 KM	5204.00
STRS0149	149.0 KM	1507.00	STRS0324	324.0 KM	2742.00	STRS0499	499.0 KM	3976.00	STRS0674	674.0 KM	5211.00
STRS0150	150.0 KM	1514.00	STRS0325	325.0 KM	2749.00	STRS0500	500.0 KM	3983.00	STRS0675	675.0 KM	5218.00
STRS0151	151.0 KM	1521.00	STRS0326	326.0 KM	2756.00	STRS0501	501.0 KM	3991.00	STRS0676	676.0 KM	5225.00
STRS0152	152.0 KM	1528.00	STRS0327	327.0 KM	2763.00	STRS0502	502.0 KM	3998.00	STRS0677	677.0 KM	5232.00
STRS0153	153.0 KM	1535.00	STRS0328	328.0 KM	2770.00	STRS0503	503.0 KM	4005.00	STRS0678	678.0 KM	5239.00
STRS0154	154.0 KM	1542.00	STRS0329	329.0 KM	2777.00	STRS0504	504.0 KM	4012.00	STRS0679	679.0 KM	5247.00
STRS0155	155.0 KM	1549.00	STRS0330	330.0 KM	2784.00	STRS0505	505.0 KM	4019.00	STRS0680	680.0 KM	5254.00
STRS0156	156.0 KM	1556.00	STRS0331	331.0 KM	2791.00	STRS0506	506.0 KM	4026.00	STRS0681	681.0 KM	5261.00
STRS0157	157.0 KM	1563.00	STRS0332	332.0 KM	2798.00	STRS0507	507.0 KM	4033.00	STRS0682	682.0 KM	5268.00
STRS0158	158.0 KM	1570.00	STRS0333	333.0 KM	2805.00	STRS0508	508.0 KM	4040.00	STRS0683	683.0 KM	5275.00
STRS0159	159.0 KM	1577.00	STRS0334	334.0 KM	2812.00	STRS0509	509.0 KM	4047.00	STRS0684	684.0 KM	5282.00

SAP Service code	Lead in KM	Rate/MT	SAP Service code	Lead in KM	Rate/MT	SAP Service code	Lead in KM	Rate/MT	SAP Service code	Lead in KM	Rate/MT
STRS0160	160.0 KM	1584.00	STRS0335	335.0 KM	2819.00	STRS0510	510.0 KM	4054.00	STRS0685	685.0 KM	5289.00
STRS0161	161.0 KM	1591.00	STRS0336	336.0 KM	2826.00	STRS0511	511.0 KM	4061.00	STRS0686	686.0 KM	5296.00
STRS0162	162.0 KM	1599.00	STRS0337	337.0 KM	2833.00	STRS0512	512.0 KM	4068.00	STRS0687	687.0 KM	5303.00
STRS0163	163.0 KM	1606.00	STRS0338	338.0 KM	2840.00	STRS0513	513.0 KM	4075.00	STRS0688	688.0 KM	5310.00
STRS0164	164.0 KM	1613.00	STRS0339	339.0 KM	2847.00	STRS0514	514.0 KM	4082.00	STRS0689	689.0 KM	5317.00
STRS0165	165.0 KM	1620.00	STRS0340	340.0 KM	2854.00	STRS0515	515.0 KM	4089.00	STRS0690	690.0 KM	5324.00
STRS0166	166.0 KM	1627.00	STRS0341	341.0 KM	2862.00	STRS0516	516.0 KM	4096.00	STRS0691	691.0 KM	5331.00
STRS0167	167.0 KM	1634.00	STRS0342	342.0 KM	2869.00	STRS0517	517.0 KM	4103.00	STRS0692	692.0 KM	5338.00
STRS0168	168.0 KM	1641.00	STRS0343	343.0 KM	2876.00	STRS0518	518.0 KM	4110.00	STRS0693	693.0 KM	5345.00
STRS0169	169.0 KM	1648.00	STRS0344	344.0 KM	2883.00	STRS0519	519.0 KM	4118.00	STRS0694	694.0 KM	5352.00
STRS0170	170.0 KM	1655.00	STRS0345	345.0 KM	2890.00	STRS0520	520.0 KM	4125.00	STRS0695	695.0 KM	5359.00
STRS0171	171.0 KM	1662.00	STRS0346	346.0 KM	2897.00	STRS0521	521.0 KM	4132.00	STRS0696	696.0 KM	5366.00
STRS0172	172.0 KM	1669.00	STRS0347	347.0 KM	2904.00	STRS0522	522.0 KM	4139.00	STRS0697	697.0 KM	5374.00
STRS0173	173.0 KM	1676.00	STRS0348	348.0 KM	2911.00	STRS0523	523.0 KM	4146.00	STRS0698	698.0 KM	5381.00
STRS0174	174.0 KM	1683.00	STRS0349	349.0 KM	2918.00	STRS0524	524.0 KM	4153.00	STRS0699	699.0 KM	5388.00
STRS0175	175.0 KM	1690.00	STRS0350	350.0 KM	2925.00	STRS0525	525.0 KM	4160.00	STRS0700	700.0 KM	5395.00

**3.TRANSPORT OF LINE MATERIALS :-**

SAP Service code	Lead in KM	Rate/MT	SAP Service code	Lead in KM	Rate/MT	SAP Service code	Lead in KM	Rate/MT	SAP Service code	Lead in KM	Rate/MT
STRL0001	1.0 KM	221	STRL0176	176.0 KM	1189	STRL0351	351.0 KM	2307	STRL0526	526.0 KM	3221
STRL0002	2.0 KM	232	STRL0177	177.0 KM	1193	STRL0352	352.0 KM	2312	STRL0527	527.0 KM	3226
STRL0003	3.0 KM	241	STRL0178	178.0 KM	1197	STRL0353	353.0 KM	2318	STRL0528	528.0 KM	3231
STRL0004	4.0 KM	252	STRL0179	179.0 KM	1202	STRL0354	354.0 KM	2323	STRL0529	529.0 KM	3236
STRL0005	5.0 KM	262	STRL0180	180.0 KM	1206	STRL0355	355.0 KM	2328	STRL0530	530.0 KM	3240
STRL0006	6.0 KM	272	STRL0181	181.0 KM	1210	STRL0356	356.0 KM	2334	STRL0531	531.0 KM	3245
STRL0007	7.0 KM	282	STRL0182	182.0 KM	1214	STRL0357	357.0 KM	2339	STRL0532	532.0 KM	3250
STRL0008	8.0 KM	292	STRL0183	183.0 KM	1219	STRL0358	358.0 KM	2345	STRL0533	533.0 KM	3255
STRL0009	9.0 KM	298	STRL0184	184.0 KM	1223	STRL0359	359.0 KM	2350	STRL0534	534.0 KM	3260
STRL0010	10.0 KM	307	STRL0185	185.0 KM	1227	STRL0360	360.0 KM	2355	STRL0535	535.0 KM	3265
STRL0011	11.0 KM	316	STRL0186	186.0 KM	1232	STRL0361	361.0 KM	2361	STRL0536	536.0 KM	3270
STRL0012	12.0 KM	336	STRL0187	187.0 KM	1236	STRL0362	362.0 KM	2366	STRL0537	537.0 KM	3275
STRL0013	13.0 KM	341	STRL0188	188.0 KM	1240	STRL0363	363.0 KM	2371	STRL0538	538.0 KM	3280
STRL0014	14.0 KM	345	STRL0189	189.0 KM	1244	STRL0364	364.0 KM	2377	STRL0539	539.0 KM	3285
STRL0015	15.0 KM	353	STRL0190	190.0 KM	1249	STRL0365	365.0 KM	2382	STRL0540	540.0 KM	3290
STRL0016	16.0 KM	357	STRL0191	191.0 KM	1253	STRL0366	366.0 KM	2387	STRL0541	541.0 KM	3295
STRL0017	17.0 KM	362	STRL0192	192.0 KM	1257	STRL0367	367.0 KM	2393	STRL0542	542.0 KM	3299
STRL0018	18.0 KM	367	STRL0193	193.0 KM	1262	STRL0368	368.0 KM	2398	STRL0543	543.0 KM	3304
STRL0019	19.0 KM	380	STRL0194	194.0 KM	1266	STRL0369	369.0 KM	2403	STRL0544	544.0 KM	3309
STRL0020	20.0 KM	388	STRL0195	195.0 KM	1270	STRL0370	370.0 KM	2409	STRL0545	545.0 KM	3314
STRL0021	21.0 KM	395	STRL0196	196.0 KM	1274	STRL0371	371.0 KM	2414	STRL0546	546.0 KM	3319
STRL0022	22.0 KM	403	STRL0197	197.0 KM	1279	STRL0372	372.0 KM	2419	STRL0547	547.0 KM	3324
STRL0023	23.0 KM	410	STRL0198	198.0 KM	1283	STRL0373	373.0 KM	2425	STRL0548	548.0 KM	3329
STRL0024	24.0 KM	417	STRL0199	199.0 KM	1287	STRL0374	374.0 KM	2430	STRL0549	549.0 KM	3334

SAP Service code	Lead in KM	Rate/MT	SAP Service code	Lead in KM	Rate/MT	SAP Service code	Lead in KM	Rate/MT	SAP Service code	Lead in KM	Rate/MT
STRL0025	25.0 KM	424	STRL0200	200.0 KM	1291	STRL0375	375.0 KM	2435	STRL0550	550.0 KM	3339
STRL0026	26.0 KM	432	STRL0201	201.0 KM	1296	STRL0376	376.0 KM	2441	STRL0551	551.0 KM	3344
STRL0027	27.0 KM	439	STRL0202	202.0 KM	1300	STRL0377	377.0 KM	2446	STRL0552	552.0 KM	3349
STRL0028	28.0 KM	446	STRL0203	203.0 KM	1304	STRL0378	378.0 KM	2451	STRL0553	553.0 KM	3354
STRL0029	29.0 KM	454	STRL0204	204.0 KM	1309	STRL0379	379.0 KM	2457	STRL0554	554.0 KM	3358
STRL0030	30.0 KM	461	STRL0205	205.0 KM	1313	STRL0380	380.0 KM	2462	STRL0555	555.0 KM	3363
STRL0031	31.0 KM	467	STRL0206	206.0 KM	1317	STRL0381	381.0 KM	2467	STRL0556	556.0 KM	3368
STRL0032	32.0 KM	474	STRL0207	207.0 KM	1321	STRL0382	382.0 KM	2473	STRL0557	557.0 KM	3373
STRL0033	33.0 KM	480	STRL0208	208.0 KM	1326	STRL0383	383.0 KM	2478	STRL0558	558.0 KM	3378
STRL0034	34.0 KM	486	STRL0209	209.0 KM	1330	STRL0384	384.0 KM	2484	STRL0559	559.0 KM	3383
STRL0035	35.0 KM	493	STRL0210	210.0 KM	1334	STRL0385	385.0 KM	2489	STRL0560	560.0 KM	3388
STRL0036	36.0 KM	499	STRL0211	211.0 KM	1339	STRL0386	386.0 KM	2494	STRL0561	561.0 KM	3393
STRL0037	37.0 KM	506	STRL0212	212.0 KM	1343	STRL0387	387.0 KM	2500	STRL0562	562.0 KM	3398
STRL0038	38.0 KM	512	STRL0213	213.0 KM	1347	STRL0388	388.0 KM	2505	STRL0563	563.0 KM	3403
STRL0039	39.0 KM	519	STRL0214	214.0 KM	1351	STRL0389	389.0 KM	2510	STRL0564	564.0 KM	3408
STRL0040	40.0 KM	525	STRL0215	215.0 KM	1356	STRL0390	390.0 KM	2516	STRL0565	565.0 KM	3413
STRL0041	41.0 KM	531	STRL0216	216.0 KM	1360	STRL0391	391.0 KM	2521	STRL0566	566.0 KM	3417
STRL0042	42.0 KM	538	STRL0217	217.0 KM	1364	STRL0392	392.0 KM	2526	STRL0567	567.0 KM	3422
STRL0043	43.0 KM	544	STRL0218	218.0 KM	1368	STRL0393	393.0 KM	2532	STRL0568	568.0 KM	3427
STRL0044	44.0 KM	551	STRL0219	219.0 KM	1373	STRL0394	394.0 KM	2537	STRL0569	569.0 KM	3432
STRL0045	45.0 KM	557	STRL0220	220.0 KM	1377	STRL0395	395.0 KM	2542	STRL0570	570.0 KM	3437
STRL0046	46.0 KM	563	STRL0221	221.0 KM	1381	STRL0396	396.0 KM	2548	STRL0571	571.0 KM	3442
STRL0047	47.0 KM	570	STRL0222	222.0 KM	1386	STRL0397	397.0 KM	2553	STRL0572	572.0 KM	3447
STRL0048	48.0 KM	576	STRL0223	223.0 KM	1390	STRL0398	398.0 KM	2558	STRL0573	573.0 KM	3452
STRL0049	49.0 KM	583	STRL0224	224.0 KM	1394	STRL0399	399.0 KM	2564	STRL0574	574.0 KM	3457

SAP Service code	Lead in KM	Rate/MT	SAP Service code	Lead in KM	Rate/MT	SAP Service code	Lead in KM	Rate/MT	SAP Service code	Lead in KM	Rate/MT
STRL0050	50.0 KM	589	STRL0225	225.0 KM	1398	STRL0400	400.0 KM	2569	STRL0575	575.0 KM	3462
STRL0051	51.0 KM	595	STRL0226	226.0 KM	1403	STRL0401	401.0 KM	2574	STRL0576	576.0 KM	3467
STRL0052	52.0 KM	601	STRL0227	227.0 KM	1407	STRL0402	402.0 KM	2580	STRL0577	577.0 KM	3472
STRL0053	53.0 KM	607	STRL0228	228.0 KM	1411	STRL0403	403.0 KM	2585	STRL0578	578.0 KM	3476
STRL0054	54.0 KM	613	STRL0229	229.0 KM	1415	STRL0404	404.0 KM	2590	STRL0579	579.0 KM	3481
STRL0055	55.0 KM	618	STRL0230	230.0 KM	1420	STRL0405	405.0 KM	2595	STRL0580	580.0 KM	3486
STRL0056	56.0 KM	624	STRL0231	231.0 KM	1424	STRL0406	406.0 KM	2600	STRL0581	581.0 KM	3491
STRL0057	57.0 KM	630	STRL0232	232.0 KM	1428	STRL0407	407.0 KM	2606	STRL0582	582.0 KM	3496
STRL0058	58.0 KM	636	STRL0233	233.0 KM	1433	STRL0408	408.0 KM	2611	STRL0583	583.0 KM	3501
STRL0059	59.0 KM	642	STRL0234	234.0 KM	1437	STRL0409	409.0 KM	2616	STRL0584	584.0 KM	3506
STRL0060	60.0 KM	648	STRL0235	235.0 KM	1441	STRL0410	410.0 KM	2621	STRL0585	585.0 KM	3511
STRL0061	61.0 KM	654	STRL0236	236.0 KM	1445	STRL0411	411.0 KM	2627	STRL0586	586.0 KM	3516
STRL0062	62.0 KM	660	STRL0237	237.0 KM	1450	STRL0412	412.0 KM	2632	STRL0587	587.0 KM	3521
STRL0063	63.0 KM	666	STRL0238	238.0 KM	1454	STRL0413	413.0 KM	2637	STRL0588	588.0 KM	3526
STRL0064	64.0 KM	671	STRL0239	239.0 KM	1458	STRL0414	414.0 KM	2642	STRL0589	589.0 KM	3531
STRL0065	65.0 KM	677	STRL0240	240.0 KM	1463	STRL0415	415.0 KM	2648	STRL0590	590.0 KM	3536
STRL0066	66.0 KM	683	STRL0241	241.0 KM	1467	STRL0416	416.0 KM	2653	STRL0591	591.0 KM	3540
STRL0067	67.0 KM	689	STRL0242	242.0 KM	1471	STRL0417	417.0 KM	2658	STRL0592	592.0 KM	3545
STRL0068	68.0 KM	695	STRL0243	243.0 KM	1475	STRL0418	418.0 KM	2663	STRL0593	593.0 KM	3550
STRL0069	69.0 KM	701	STRL0244	244.0 KM	1480	STRL0419	419.0 KM	2669	STRL0594	594.0 KM	3555
STRL0070	70.0 KM	707	STRL0245	245.0 KM	1484	STRL0420	420.0 KM	2674	STRL0595	595.0 KM	3560
STRL0071	71.0 KM	713	STRL0246	246.0 KM	1488	STRL0421	421.0 KM	2679	STRL0596	596.0 KM	3565
STRL0072	72.0 KM	718	STRL0247	247.0 KM	1492	STRL0422	422.0 KM	2684	STRL0597	597.0 KM	3570
STRL0073	73.0 KM	724	STRL0248	248.0 KM	1497	STRL0423	423.0 KM	2690	STRL0598	598.0 KM	3575
STRL0074	74.0 KM	730	STRL0249	249.0 KM	1501	STRL0424	424.0 KM	2695	STRL0599	599.0 KM	3580



SAP Service code	Lead in KM	Rate/MT	SAP Service code	Lead in KM	Rate/MT	SAP Service code	Lead in KM	Rate/MT	SAP Service code	Lead in KM	Rate/MT
STRL0075	75.0 KM	736	STRL0250	250.0 KM	1505	STRL0425	425.0 KM	2700	STRL0600	600.0 KM	3585
STRL0076	76.0 KM	742	STRL0251	251.0 KM	1746	STRL0426	426.0 KM	2705	STRL0601	601.0 KM	3590
STRL0077	77.0 KM	748	STRL0252	252.0 KM	1752	STRL0427	427.0 KM	2710	STRL0602	602.0 KM	3595
STRL0078	78.0 KM	754	STRL0253	253.0 KM	1758	STRL0428	428.0 KM	2716	STRL0603	603.0 KM	3599
STRL0079	79.0 KM	760	STRL0254	254.0 KM	1764	STRL0429	429.0 KM	2721	STRL0604	604.0 KM	3604
STRL0080	80.0 KM	765	STRL0255	255.0 KM	1770	STRL0430	430.0 KM	2726	STRL0605	605.0 KM	3609
STRL0081	81.0 KM	770	STRL0256	256.0 KM	1776	STRL0431	431.0 KM	2731	STRL0606	606.0 KM	3614
STRL0082	82.0 KM	775	STRL0257	257.0 KM	1782	STRL0432	432.0 KM	2737	STRL0607	607.0 KM	3619
STRL0083	83.0 KM	780	STRL0258	258.0 KM	1788	STRL0433	433.0 KM	2742	STRL0608	608.0 KM	3624
STRL0084	84.0 KM	785	STRL0259	259.0 KM	1793	STRL0434	434.0 KM	2747	STRL0609	609.0 KM	3629
STRL0085	85.0 KM	790	STRL0260	260.0 KM	1799	STRL0435	435.0 KM	2752	STRL0610	610.0 KM	3634
STRL0086	86.0 KM	795	STRL0261	261.0 KM	1805	STRL0436	436.0 KM	2758	STRL0611	611.0 KM	3639
STRL0087	87.0 KM	800	STRL0262	262.0 KM	1811	STRL0437	437.0 KM	2763	STRL0612	612.0 KM	3644
STRL0088	88.0 KM	805	STRL0263	263.0 KM	1817	STRL0438	438.0 KM	2768	STRL0613	613.0 KM	3649
STRL0089	89.0 KM	810	STRL0264	264.0 KM	1823	STRL0439	439.0 KM	2773	STRL0614	614.0 KM	3654
STRL0090	90.0 KM	815	STRL0265	265.0 KM	1829	STRL0440	440.0 KM	2779	STRL0615	615.0 KM	3658
STRL0091	91.0 KM	820	STRL0266	266.0 KM	1835	STRL0441	441.0 KM	2784	STRL0616	616.0 KM	3663
STRL0092	92.0 KM	824	STRL0267	267.0 KM	1840	STRL0442	442.0 KM	2789	STRL0617	617.0 KM	3668
STRL0093	93.0 KM	829	STRL0268	268.0 KM	1846	STRL0443	443.0 KM	2794	STRL0618	618.0 KM	3673
STRL0094	94.0 KM	834	STRL0269	269.0 KM	1852	STRL0444	444.0 KM	2800	STRL0619	619.0 KM	3678
STRL0095	95.0 KM	839	STRL0270	270.0 KM	1858	STRL0445	445.0 KM	2805	STRL0620	620.0 KM	3683
STRL0096	96.0 KM	844	STRL0271	271.0 KM	1864	STRL0446	446.0 KM	2810	STRL0621	621.0 KM	3688
STRL0097	97.0 KM	849	STRL0272	272.0 KM	1870	STRL0447	447.0 KM	2815	STRL0622	622.0 KM	3693
STRL0098	98.0 KM	854	STRL0273	273.0 KM	1876	STRL0448	448.0 KM	2820	STRL0623	623.0 KM	3698
STRL0099	99.0 KM	859	STRL0274	274.0 KM	1882	STRL0449	449.0 KM	2826	STRL0624	624.0 KM	3703

SAP Service code	Lead in KM	Rate/MT	SAP Service code	Lead in KM	Rate/MT	SAP Service code	Lead in KM	Rate/MT	SAP Service code	Lead in KM	Rate/MT
STRL0100	100.0 KM	864	STRL0275	275.0 KM	1887	STRL0450	450.0 KM	2831	STRL0625	625.0 KM	3708
STRL0101	101.0 KM	868	STRL0276	276.0 KM	1893	STRL0451	451.0 KM	2836	STRL0626	626.0 KM	3713
STRL0102	102.0 KM	872	STRL0277	277.0 KM	1899	STRL0452	452.0 KM	2841	STRL0627	627.0 KM	3717
STRL0103	103.0 KM	877	STRL0278	278.0 KM	1905	STRL0453	453.0 KM	2847	STRL0628	628.0 KM	3722
STRL0104	104.0 KM	881	STRL0279	279.0 KM	1911	STRL0454	454.0 KM	2852	STRL0629	629.0 KM	3727
STRL0105	105.0 KM	885	STRL0280	280.0 KM	1917	STRL0455	455.0 KM	2857	STRL0630	630.0 KM	3732
STRL0106	106.0 KM	889	STRL0281	281.0 KM	1923	STRL0456	456.0 KM	2862	STRL0631	631.0 KM	3737
STRL0107	107.0 KM	894	STRL0282	282.0 KM	1929	STRL0457	457.0 KM	2868	STRL0632	632.0 KM	3742
STRL0108	108.0 KM	898	STRL0283	283.0 KM	1935	STRL0458	458.0 KM	2873	STRL0633	633.0 KM	3747
STRL0109	109.0 KM	902	STRL0284	284.0 KM	1940	STRL0459	459.0 KM	2878	STRL0634	634.0 KM	3752
STRL0110	110.0 KM	907	STRL0285	285.0 KM	1946	STRL0460	460.0 KM	2883	STRL0635	635.0 KM	3757
STRL0111	111.0 KM	911	STRL0286	286.0 KM	1952	STRL0461	461.0 KM	2889	STRL0636	636.0 KM	3762
STRL0112	112.0 KM	915	STRL0287	287.0 KM	1958	STRL0462	462.0 KM	2894	STRL0637	637.0 KM	3767
STRL0113	113.0 KM	919	STRL0288	288.0 KM	1964	STRL0463	463.0 KM	2899	STRL0638	638.0 KM	3772
STRL0114	114.0 KM	924	STRL0289	289.0 KM	1970	STRL0464	464.0 KM	2904	STRL0639	639.0 KM	3776
STRL0115	115.0 KM	928	STRL0290	290.0 KM	1976	STRL0465	465.0 KM	2910	STRL0640	640.0 KM	3781
STRL0116	116.0 KM	932	STRL0291	291.0 KM	1982	STRL0466	466.0 KM	2915	STRL0641	641.0 KM	3786
STRL0117	117.0 KM	937	STRL0292	292.0 KM	1987	STRL0467	467.0 KM	2920	STRL0642	642.0 KM	3791
STRL0118	118.0 KM	941	STRL0293	293.0 KM	1993	STRL0468	468.0 KM	2925	STRL0643	643.0 KM	3796
STRL0119	119.0 KM	945	STRL0294	294.0 KM	1999	STRL0469	469.0 KM	2931	STRL0644	644.0 KM	3801
STRL0120	120.0 KM	949	STRL0295	295.0 KM	2005	STRL0470	470.0 KM	2936	STRL0645	645.0 KM	3806
STRL0121	121.0 KM	954	STRL0296	296.0 KM	2011	STRL0471	471.0 KM	2941	STRL0646	646.0 KM	3811
STRL0122	122.0 KM	958	STRL0297	297.0 KM	2017	STRL0472	472.0 KM	2946	STRL0647	647.0 KM	3816
STRL0123	123.0 KM	962	STRL0298	298.0 KM	2023	STRL0473	473.0 KM	2951	STRL0648	648.0 KM	3821
STRL0124	124.0 KM	966	STRL0299	299.0 KM	2029	STRL0474	474.0 KM	2957	STRL0649	649.0 KM	3826

SAP Service code	Lead in KM	Rate/MT	SAP Service code	Lead in KM	Rate/MT	SAP Service code	Lead in KM	Rate/MT	SAP Service code	Lead in KM	Rate/MT
STRL0125	125.0 KM	971	STRL0300	300.0 KM	2034	STRL0475	475.0 KM	2962	STRL0650	650.0 KM	3831
STRL0126	126.0 KM	975	STRL0301	301.0 KM	2040	STRL0476	476.0 KM	2967	STRL0651	651.0 KM	3836
STRL0127	127.0 KM	979	STRL0302	302.0 KM	2045	STRL0477	477.0 KM	2972	STRL0652	652.0 KM	3840
STRL0128	128.0 KM	984	STRL0303	303.0 KM	2051	STRL0478	478.0 KM	2978	STRL0653	653.0 KM	3845
STRL0129	129.0 KM	988	STRL0304	304.0 KM	2056	STRL0479	479.0 KM	2983	STRL0654	654.0 KM	3850
STRL0130	130.0 KM	992	STRL0305	305.0 KM	2061	STRL0480	480.0 KM	2988	STRL0655	655.0 KM	3855
STRL0131	131.0 KM	996	STRL0306	306.0 KM	2067	STRL0481	481.0 KM	2993	STRL0656	656.0 KM	3860
STRL0132	132.0 KM	1001	STRL0307	307.0 KM	2072	STRL0482	482.0 KM	2999	STRL0657	657.0 KM	3865
STRL0133	133.0 KM	1005	STRL0308	308.0 KM	2077	STRL0483	483.0 KM	3004	STRL0658	658.0 KM	3870
STRL0134	134.0 KM	1009	STRL0309	309.0 KM	2083	STRL0484	484.0 KM	3009	STRL0659	659.0 KM	3875
STRL0135	135.0 KM	1014	STRL0310	310.0 KM	2088	STRL0485	485.0 KM	3014	STRL0660	660.0 KM	3880
STRL0136	136.0 KM	1018	STRL0311	311.0 KM	2093	STRL0486	486.0 KM	3020	STRL0661	661.0 KM	3885
STRL0137	137.0 KM	1022	STRL0312	312.0 KM	2099	STRL0487	487.0 KM	3025	STRL0662	662.0 KM	3890
STRL0138	138.0 KM	1026	STRL0313	313.0 KM	2104	STRL0488	488.0 KM	3030	STRL0663	663.0 KM	3895
STRL0139	139.0 KM	1031	STRL0314	314.0 KM	2109	STRL0489	489.0 KM	3035	STRL0664	664.0 KM	3899
STRL0140	140.0 KM	1035	STRL0315	315.0 KM	2115	STRL0490	490.0 KM	3041	STRL0665	665.0 KM	3904
STRL0141	141.0 KM	1039	STRL0316	316.0 KM	2120	STRL0491	491.0 KM	3046	STRL0666	666.0 KM	3909
STRL0142	142.0 KM	1043	STRL0317	317.0 KM	2125	STRL0492	492.0 KM	3051	STRL0667	667.0 KM	3914
STRL0143	143.0 KM	1048	STRL0318	318.0 KM	2131	STRL0493	493.0 KM	3056	STRL0668	668.0 KM	3919
STRL0144	144.0 KM	1052	STRL0319	319.0 KM	2136	STRL0494	494.0 KM	3061	STRL0669	669.0 KM	3924
STRL0145	145.0 KM	1056	STRL0320	320.0 KM	2141	STRL0495	495.0 KM	3067	STRL0670	670.0 KM	3929
STRL0146	146.0 KM	1061	STRL0321	321.0 KM	2147	STRL0496	496.0 KM	3072	STRL0671	671.0 KM	3934
STRL0147	147.0 KM	1065	STRL0322	322.0 KM	2152	STRL0497	497.0 KM	3077	STRL0672	672.0 KM	3939
STRL0148	148.0 KM	1069	STRL0323	323.0 KM	2157	STRL0498	498.0 KM	3082	STRL0673	673.0 KM	3944
STRL0149	149.0 KM	1073	STRL0324	324.0 KM	2163	STRL0499	499.0 KM	3088	STRL0674	674.0 KM	3949

SAP Service code	Lead in KM	Rate/MT	SAP Service code	Lead in KM	Rate/MT	SAP Service code	Lead in KM	Rate/MT	SAP Service code	Lead in KM	Rate/MT
STRL0150	150.0 KM	1078	STRL0325	325.0 KM	2168	STRL0500	500.0 KM	3093	STRL0675	675.0 KM	3954
STRL0151	151.0 KM	1082	STRL0326	326.0 KM	2173	STRL0501	501.0 KM	3098	STRL0676	676.0 KM	3958
STRL0152	152.0 KM	1086	STRL0327	327.0 KM	2179	STRL0502	502.0 KM	3103	STRL0677	677.0 KM	3963
STRL0153	153.0 KM	1090	STRL0328	328.0 KM	2184	STRL0503	503.0 KM	3108	STRL0678	678.0 KM	3968
STRL0154	154.0 KM	1095	STRL0329	329.0 KM	2190	STRL0504	504.0 KM	3113	STRL0679	679.0 KM	3973
STRL0155	155.0 KM	1099	STRL0330	330.0 KM	2195	STRL0505	505.0 KM	3117	STRL0680	680.0 KM	3978
STRL0156	156.0 KM	1103	STRL0331	331.0 KM	2200	STRL0506	506.0 KM	3122	STRL0681	681.0 KM	3983
STRL0157	157.0 KM	1108	STRL0332	332.0 KM	2206	STRL0507	507.0 KM	3127	STRL0682	682.0 KM	3988
STRL0158	158.0 KM	1112	STRL0333	333.0 KM	2211	STRL0508	508.0 KM	3132	STRL0683	683.0 KM	3993
STRL0159	159.0 KM	1116	STRL0334	334.0 KM	2216	STRL0509	509.0 KM	3137	STRL0684	684.0 KM	3998
STRL0160	160.0 KM	1120	STRL0335	335.0 KM	2222	STRL0510	510.0 KM	3142	STRL0685	685.0 KM	4003
STRL0161	161.0 KM	1125	STRL0336	336.0 KM	2227	STRL0511	511.0 KM	3147	STRL0686	686.0 KM	4008
STRL0162	162.0 KM	1129	STRL0337	337.0 KM	2232	STRL0512	512.0 KM	3152	STRL0687	687.0 KM	4013
STRL0163	163.0 KM	1133	STRL0338	338.0 KM	2238	STRL0513	513.0 KM	3157	STRL0688	688.0 KM	4017
STRL0164	164.0 KM	1138	STRL0339	339.0 KM	2243	STRL0514	514.0 KM	3162	STRL0689	689.0 KM	4022
STRL0165	165.0 KM	1142	STRL0340	340.0 KM	2248	STRL0515	515.0 KM	3167	STRL0690	690.0 KM	4027
STRL0166	166.0 KM	1146	STRL0341	341.0 KM	2254	STRL0516	516.0 KM	3172	STRL0691	691.0 KM	4032
STRL0167	167.0 KM	1150	STRL0342	342.0 KM	2259	STRL0517	517.0 KM	3177	STRL0692	692.0 KM	4037
STRL0168	168.0 KM	1155	STRL0343	343.0 KM	2264	STRL0518	518.0 KM	3181	STRL0693	693.0 KM	4042
STRL0169	169.0 KM	1159	STRL0344	344.0 KM	2270	STRL0519	519.0 KM	3186	STRL0694	694.0 KM	4047
STRL0170	170.0 KM	1163	STRL0345	345.0 KM	2275	STRL0520	520.0 KM	3191	STRL0695	695.0 KM	4052
STRL0171	171.0 KM	1167	STRL0346	346.0 KM	2280	STRL0521	521.0 KM	3196	STRL0696	696.0 KM	4057
STRL0172	172.0 KM	1172	STRL0347	347.0 KM	2286	STRL0522	522.0 KM	3201	STRL0697	697.0 KM	4062
STRL0173	173.0 KM	1176	STRL0348	348.0 KM	2291	STRL0523	523.0 KM	3206	STRL0698	698.0 KM	4067
STRL0174	174.0 KM	1180	STRL0349	349.0 KM	2296	STRL0524	524.0 KM	3211	STRL0699	699.0 KM	4072
STRL0175	175.0 KM	1185	STRL0350	350.0 KM	2302	STRL0525	525.0 KM	3216	STRL0700	700.0 KM	4076

**NOTE :**

- a) Higher rates may be allowed in the marginal limits of slab.
- b) In respect of scattered works, and part loads, the above rates are applicable for working out load KM. This should be applied in the event of necessity for transport of part loads and where there is no scope for utilization of department lorries.
- c) Transport of conductor drums, transformer oil drums, and fragile materials such as kiosks, L.As, Insulators, Transformers, Meters etc., which occupy more space and less weight, the rates with 20% excess over the rates for line materials shall be adopted. Loading and unloading charges are payable extra.

**4. Transport Of PSSC/Spun Poles:****a. Pole weights:**

Sl No	Type of pole	Weight in Kg/Pole
1	8m/140Kg PSSC pole	355 Kg
2	8m/200Kg PSSC pole	380 Kg
3	8m/300Kg PSSC pole	505 Kg
4	9.1m/280Kg PSSC pole	680 Kg
5	11m/365Kg PSSC Pole	1127Kg
6	9.5m/300Kg SPUN pole	620 Kg
7	11m/350Kg SPUN pole	900 Kg
8	12.5m/350Kg SPUN pole	1200 Kg

- b. **Transport by head loads:**..In case of hilly areas 30% extra is to be allowed for transport of poles by head loads.
- c. **Transport by bullock carts:**.. Up to 8.0 KM, a rate of **Rs.121.00** per pole is to be adopted excluding loading and unloading charges.
- d. **Transport by lorries:-**The rates per Metric Tone are excluding the loading and unloading charges.

SAP Service code	Lead in KM	Rate/MT	SAP Service code	Lead in KM	Rate/MT	SAP Service code	Lead in KM	Rate/MT	SAP Service code	Lead in KM	Rate/MT
STRP0001	1.0 KM	284.00	STRP0176	176.0 KM	1668.00	STRP0351	351.0 KM	3163.00	STRP0526	526.0 KM	4458.00
STRP0002	2.0 KM	303.00	STRP0177	177.0 KM	1674.00	STRP0352	352.0 KM	3171.00	STRP0527	527.0 KM	4466.00
STRP0003	3.0 KM	313.00	STRP0178	178.0 KM	1681.00	STRP0353	353.0 KM	3178.00	STRP0528	528.0 KM	4473.00
STRP0004	4.0 KM	327.00	STRP0179	179.0 KM	1687.00	STRP0354	354.0 KM	3186.00	STRP0529	529.0 KM	4480.00
STRP0005	5.0 KM	338.00	STRP0180	180.0 KM	1693.00	STRP0355	355.0 KM	3194.00	STRP0530	530.0 KM	4487.00
STRP0006	6.0 KM	354.00	STRP0181	181.0 KM	1700.00	STRP0356	356.0 KM	3202.00	STRP0531	531.0 KM	4494.00
STRP0007	7.0 KM	367.00	STRP0182	182.0 KM	1706.00	STRP0357	357.0 KM	3210.00	STRP0532	532.0 KM	4501.00
STRP0008	8.0 KM	381.00	STRP0183	183.0 KM	1713.00	STRP0358	358.0 KM	3217.00	STRP0533	533.0 KM	4509.00
STRP0009	9.0 KM	396.00	STRP0184	184.0 KM	1719.00	STRP0359	359.0 KM	3225.00	STRP0534	534.0 KM	4516.00
STRP0010	10.0 KM	411.00	STRP0185	185.0 KM	1726.00	STRP0360	360.0 KM	3233.00	STRP0535	535.0 KM	4523.00
STRP0011	11.0 KM	426.00	STRP0186	186.0 KM	1732.00	STRP0361	361.0 KM	3241.00	STRP0536	536.0 KM	4530.00
STRP0012	12.0 KM	428.00	STRP0187	187.0 KM	1738.00	STRP0362	362.0 KM	3249.00	STRP0537	537.0 KM	4537.00
STRP0013	13.0 KM	431.00	STRP0188	188.0 KM	1745.00	STRP0363	363.0 KM	3256.00	STRP0538	538.0 KM	4544.00
STRP0014	14.0 KM	438.00	STRP0189	189.0 KM	1751.00	STRP0364	364.0 KM	3264.00	STRP0539	539.0 KM	4551.00
STRP0015	15.0 KM	459.00	STRP0190	190.0 KM	1758.00	STRP0365	365.0 KM	3272.00	STRP0540	540.0 KM	4559.00
STRP0016	16.0 KM	462.00	STRP0191	191.0 KM	1764.00	STRP0366	366.0 KM	3280.00	STRP0541	541.0 KM	4566.00
STRP0017	17.0 KM	464.00	STRP0192	192.0 KM	1770.00	STRP0367	367.0 KM	3288.00	STRP0542	542.0 KM	4573.00
STRP0018	18.0 KM	478.00	STRP0193	193.0 KM	1777.00	STRP0368	368.0 KM	3295.00	STRP0543	543.0 KM	4580.00
STRP0019	19.0 KM	491.00	STRP0194	194.0 KM	1783.00	STRP0369	369.0 KM	3303.00	STRP0544	544.0 KM	4587.00
STRP0020	20.0 KM	520.00	STRP0195	195.0 KM	1790.00	STRP0370	370.0 KM	3311.00	STRP0545	545.0 KM	4594.00
STRP0021	21.0 KM	530.00	STRP0196	196.0 KM	1796.00	STRP0371	371.0 KM	3319.00	STRP0546	546.0 KM	4602.00
STRP0022	22.0 KM	541.00	STRP0197	197.0 KM	1803.00	STRP0372	372.0 KM	3327.00	STRP0547	547.0 KM	4609.00
STRP0023	23.0 KM	551.00	STRP0198	198.0 KM	1809.00	STRP0373	373.0 KM	3334.00	STRP0548	548.0 KM	4616.00
STRP0024	24.0 KM	562.00	STRP0199	199.0 KM	1815.00	STRP0374	374.0 KM	3342.00	STRP0549	549.0 KM	4623.00
STRP0025	25.0 KM	573.00	STRP0200	200.0 KM	1822.00	STRP0375	375.0 KM	3350.00	STRP0550	550.0 KM	4630.00
STRP0026	26.0 KM	583.00	STRP0201	201.0 KM	1828.00	STRP0376	376.0 KM	3358.00	STRP0551	551.0 KM	4637.00
STRP0027	27.0 KM	594.00	STRP0202	202.0 KM	1835.00	STRP0377	377.0 KM	3366.00	STRP0552	552.0 KM	4645.00
STRP0028	28.0 KM	604.00	STRP0203	203.0 KM	1841.00	STRP0378	378.0 KM	3373.00	STRP0553	553.0 KM	4652.00
STRP0029	29.0 KM	615.00	STRP0204	204.0 KM	1847.00	STRP0379	379.0 KM	3381.00	STRP0554	554.0 KM	4659.00
STRP0030	30.0 KM	625.00	STRP0205	205.0 KM	1854.00	STRP0380	380.0 KM	3389.00	STRP0555	555.0 KM	4666.00
STRP0031	31.0 KM	634.00	STRP0206	206.0 KM	1860.00	STRP0381	381.0 KM	3397.00	STRP0556	556.0 KM	4673.00

SAP Service code	Lead in KM	Rate/MT	SAP Service code	Lead in KM	Rate/MT	SAP Service code	Lead in KM	Rate/MT	SAP Service code	Lead in KM	Rate/MT
STRP0032	32.0 KM	643.00	STRP0207	207.0 KM	1867.00	STRP0382	382.0 KM	3405.00	STRP0557	557.0 KM	4680.00
STRP0033	33.0 KM	652.00	STRP0208	208.0 KM	1873.00	STRP0383	383.0 KM	3412.00	STRP0558	558.0 KM	4688.00
STRP0034	34.0 KM	660.00	STRP0209	209.0 KM	1879.00	STRP0384	384.0 KM	3420.00	STRP0559	559.0 KM	4695.00
STRP0035	35.0 KM	669.00	STRP0210	210.0 KM	1886.00	STRP0385	385.0 KM	3428.00	STRP0560	560.0 KM	4702.00
STRP0036	36.0 KM	678.00	STRP0211	211.0 KM	1892.00	STRP0386	386.0 KM	3436.00	STRP0561	561.0 KM	4709.00
STRP0037	37.0 KM	687.00	STRP0212	212.0 KM	1899.00	STRP0387	387.0 KM	3444.00	STRP0562	562.0 KM	4716.00
STRP0038	38.0 KM	696.00	STRP0213	213.0 KM	1905.00	STRP0388	388.0 KM	3451.00	STRP0563	563.0 KM	4723.00
STRP0039	39.0 KM	704.00	STRP0214	214.0 KM	1912.00	STRP0389	389.0 KM	3459.00	STRP0564	564.0 KM	4731.00
STRP0040	40.0 KM	713.00	STRP0215	215.0 KM	1918.00	STRP0390	390.0 KM	3467.00	STRP0565	565.0 KM	4738.00
STRP0041	41.0 KM	722.00	STRP0216	216.0 KM	1924.00	STRP0391	391.0 KM	3475.00	STRP0566	566.0 KM	4745.00
STRP0042	42.0 KM	731.00	STRP0217	217.0 KM	1931.00	STRP0392	392.0 KM	3483.00	STRP0567	567.0 KM	4752.00
STRP0043	43.0 KM	739.00	STRP0218	218.0 KM	1937.00	STRP0393	393.0 KM	3491.00	STRP0568	568.0 KM	4759.00
STRP0044	44.0 KM	748.00	STRP0219	219.0 KM	1944.00	STRP0394	394.0 KM	3498.00	STRP0569	569.0 KM	4766.00
STRP0045	45.0 KM	757.00	STRP0220	220.0 KM	1950.00	STRP0395	395.0 KM	3506.00	STRP0570	570.0 KM	4774.00
STRP0046	46.0 KM	766.00	STRP0221	221.0 KM	1956.00	STRP0396	396.0 KM	3514.00	STRP0571	571.0 KM	4781.00
STRP0047	47.0 KM	774.00	STRP0222	222.0 KM	1963.00	STRP0397	397.0 KM	3522.00	STRP0572	572.0 KM	4788.00
STRP0048	48.0 KM	783.00	STRP0223	223.0 KM	1969.00	STRP0398	398.0 KM	3530.00	STRP0573	573.0 KM	4795.00
STRP0049	49.0 KM	792.00	STRP0224	224.0 KM	1976.00	STRP0399	399.0 KM	3537.00	STRP0574	574.0 KM	4802.00
STRP0050	50.0 KM	801.00	STRP0225	225.0 KM	1982.00	STRP0400	400.0 KM	3545.00	STRP0575	575.0 KM	4809.00
STRP0051	51.0 KM	809.00	STRP0226	226.0 KM	1989.00	STRP0401	401.0 KM	3552.00	STRP0576	576.0 KM	4817.00
STRP0052	52.0 KM	817.00	STRP0227	227.0 KM	1995.00	STRP0402	402.0 KM	3560.00	STRP0577	577.0 KM	4824.00
STRP0053	53.0 KM	825.00	STRP0228	228.0 KM	2001.00	STRP0403	403.0 KM	3567.00	STRP0578	578.0 KM	4831.00
STRP0054	54.0 KM	833.00	STRP0229	229.0 KM	2008.00	STRP0404	404.0 KM	3574.00	STRP0579	579.0 KM	4838.00
STRP0055	55.0 KM	841.00	STRP0230	230.0 KM	2014.00	STRP0405	405.0 KM	3581.00	STRP0580	580.0 KM	4845.00
STRP0056	56.0 KM	849.00	STRP0231	231.0 KM	2021.00	STRP0406	406.0 KM	3589.00	STRP0581	581.0 KM	4852.00
STRP0057	57.0 KM	857.00	STRP0232	232.0 KM	2027.00	STRP0407	407.0 KM	3596.00	STRP0582	582.0 KM	4859.00
STRP0058	58.0 KM	865.00	STRP0233	233.0 KM	2033.00	STRP0408	408.0 KM	3603.00	STRP0583	583.0 KM	4867.00
STRP0059	59.0 KM	873.00	STRP0234	234.0 KM	2040.00	STRP0409	409.0 KM	3611.00	STRP0584	584.0 KM	4874.00
STRP0060	60.0 KM	881.00	STRP0235	235.0 KM	2046.00	STRP0410	410.0 KM	3618.00	STRP0585	585.0 KM	4881.00
STRP0061	61.0 KM	889.00	STRP0236	236.0 KM	2053.00	STRP0411	411.0 KM	3625.00	STRP0586	586.0 KM	4888.00
STRP0062	62.0 KM	897.00	STRP0237	237.0 KM	2059.00	STRP0412	412.0 KM	3632.00	STRP0587	587.0 KM	4895.00
STRP0063	63.0 KM	905.00	STRP0238	238.0 KM	2066.00	STRP0413	413.0 KM	3640.00	STRP0588	588.0 KM	4902.00
STRP0064	64.0 KM	913.00	STRP0239	239.0 KM	2072.00	STRP0414	414.0 KM	3647.00	STRP0589	589.0 KM	4910.00

SAP Service code	Lead in KM	Rate/MT	SAP Service code	Lead in KM	Rate/MT	SAP Service code	Lead in KM	Rate/MT	SAP Service code	Lead in KM	Rate/MT
STRP0065	65.0 KM	921.00	STRP0240	240.0 KM	2078.00	STRP0415	415.0 KM	3654.00	STRP0590	590.0 KM	4917.00
STRP0066	66.0 KM	929.00	STRP0241	241.0 KM	2085.00	STRP0416	416.0 KM	3661.00	STRP0591	591.0 KM	4924.00
STRP0067	67.0 KM	937.00	STRP0242	242.0 KM	2091.00	STRP0417	417.0 KM	3669.00	STRP0592	592.0 KM	4931.00
STRP0068	68.0 KM	945.00	STRP0243	243.0 KM	2098.00	STRP0418	418.0 KM	3676.00	STRP0593	593.0 KM	4938.00
STRP0069	69.0 KM	953.00	STRP0244	244.0 KM	2104.00	STRP0419	419.0 KM	3683.00	STRP0594	594.0 KM	4945.00
STRP0070	70.0 KM	961.00	STRP0245	245.0 KM	2110.00	STRP0420	420.0 KM	3691.00	STRP0595	595.0 KM	4953.00
STRP0071	71.0 KM	969.00	STRP0246	246.0 KM	2117.00	STRP0421	421.0 KM	3698.00	STRP0596	596.0 KM	4960.00
STRP0072	72.0 KM	977.00	STRP0247	247.0 KM	2123.00	STRP0422	422.0 KM	3705.00	STRP0597	597.0 KM	4967.00
STRP0073	73.0 KM	985.00	STRP0248	248.0 KM	2130.00	STRP0423	423.0 KM	3712.00	STRP0598	598.0 KM	4974.00
STRP0074	74.0 KM	993.00	STRP0249	249.0 KM	2136.00	STRP0424	424.0 KM	3720.00	STRP0599	599.0 KM	4981.00
STRP0075	75.0 KM	1001.00	STRP0250	250.0 KM	2142.00	STRP0425	425.0 KM	3727.00	STRP0600	600.0 KM	4988.00
STRP0076	76.0 KM	1009.00	STRP0251	251.0 KM	2372.00	STRP0426	426.0 KM	3734.00	STRP0601	601.0 KM	4996.00
STRP0077	77.0 KM	1017.00	STRP0252	252.0 KM	2380.00	STRP0427	427.0 KM	3741.00	STRP0602	602.0 KM	5003.00
STRP0078	78.0 KM	1025.00	STRP0253	253.0 KM	2388.00	STRP0428	428.0 KM	3749.00	STRP0603	603.0 KM	5010.00
STRP0079	79.0 KM	1033.00	STRP0254	254.0 KM	2396.00	STRP0429	429.0 KM	3756.00	STRP0604	604.0 KM	5017.00
STRP0080	80.0 KM	1041.00	STRP0255	255.0 KM	2404.00	STRP0430	430.0 KM	3763.00	STRP0605	605.0 KM	5024.00
STRP0081	81.0 KM	1048.00	STRP0256	256.0 KM	2412.00	STRP0431	431.0 KM	3771.00	STRP0606	606.0 KM	5031.00
STRP0082	82.0 KM	1055.00	STRP0257	257.0 KM	2420.00	STRP0432	432.0 KM	3778.00	STRP0607	607.0 KM	5039.00
STRP0083	83.0 KM	1062.00	STRP0258	258.0 KM	2428.00	STRP0433	433.0 KM	3785.00	STRP0608	608.0 KM	5046.00
STRP0084	84.0 KM	1069.00	STRP0259	259.0 KM	2436.00	STRP0434	434.0 KM	3792.00	STRP0609	609.0 KM	5053.00
STRP0085	85.0 KM	1076.00	STRP0260	260.0 KM	2444.00	STRP0435	435.0 KM	3800.00	STRP0610	610.0 KM	5060.00
STRP0086	86.0 KM	1083.00	STRP0261	261.0 KM	2452.00	STRP0436	436.0 KM	3807.00	STRP0611	611.0 KM	5067.00
STRP0087	87.0 KM	1090.00	STRP0262	262.0 KM	2460.00	STRP0437	437.0 KM	3814.00	STRP0612	612.0 KM	5074.00
STRP0088	88.0 KM	1097.00	STRP0263	263.0 KM	2468.00	STRP0438	438.0 KM	3821.00	STRP0613	613.0 KM	5082.00
STRP0089	89.0 KM	1104.00	STRP0264	264.0 KM	2476.00	STRP0439	439.0 KM	3829.00	STRP0614	614.0 KM	5089.00
STRP0090	90.0 KM	1111.00	STRP0265	265.0 KM	2484.00	STRP0440	440.0 KM	3836.00	STRP0615	615.0 KM	5096.00
STRP0091	91.0 KM	1118.00	STRP0266	266.0 KM	2492.00	STRP0441	441.0 KM	3843.00	STRP0616	616.0 KM	5103.00
STRP0092	92.0 KM	1125.00	STRP0267	267.0 KM	2500.00	STRP0442	442.0 KM	3850.00	STRP0617	617.0 KM	5110.00
STRP0093	93.0 KM	1132.00	STRP0268	268.0 KM	2508.00	STRP0443	443.0 KM	3858.00	STRP0618	618.0 KM	5117.00
STRP0094	94.0 KM	1139.00	STRP0269	269.0 KM	2516.00	STRP0444	444.0 KM	3865.00	STRP0619	619.0 KM	5125.00
STRP0095	95.0 KM	1146.00	STRP0270	270.0 KM	2524.00	STRP0445	445.0 KM	3872.00	STRP0620	620.0 KM	5132.00
STRP0096	96.0 KM	1152.00	STRP0271	271.0 KM	2532.00	STRP0446	446.0 KM	3880.00	STRP0621	621.0 KM	5139.00
STRP0097	97.0 KM	1159.00	STRP0272	272.0 KM	2540.00	STRP0447	447.0 KM	3887.00	STRP0622	622.0 KM	5146.00



SAP Service code	Lead in KM	Rate/MT	SAP Service code	Lead in KM	Rate/MT	SAP Service code	Lead in KM	Rate/MT	SAP Service code	Lead in KM	Rate/MT
STRP0098	98.0 KM	1166.00	STRP0273	273.0 KM	2548.00	STRP0448	448.0 KM	3894.00	STRP0623	623.0 KM	5153.00
STRP0099	99.0 KM	1173.00	STRP0274	274.0 KM	2556.00	STRP0449	449.0 KM	3901.00	STRP0624	624.0 KM	5160.00
STRP0100	100.0 KM	1180.00	STRP0275	275.0 KM	2564.00	STRP0450	450.0 KM	3909.00	STRP0625	625.0 KM	5167.00
STRP0101	101.0 KM	1187.00	STRP0276	276.0 KM	2572.00	STRP0451	451.0 KM	3916.00	STRP0626	626.0 KM	5175.00
STRP0102	102.0 KM	1193.00	STRP0277	277.0 KM	2580.00	STRP0452	452.0 KM	3923.00	STRP0627	627.0 KM	5182.00
STRP0103	103.0 KM	1200.00	STRP0278	278.0 KM	2588.00	STRP0453	453.0 KM	3930.00	STRP0628	628.0 KM	5189.00
STRP0104	104.0 KM	1206.00	STRP0279	279.0 KM	2596.00	STRP0454	454.0 KM	3938.00	STRP0629	629.0 KM	5196.00
STRP0105	105.0 KM	1212.00	STRP0280	280.0 KM	2604.00	STRP0455	455.0 KM	3945.00	STRP0630	630.0 KM	5203.00
STRP0106	106.0 KM	1219.00	STRP0281	281.0 KM	2612.00	STRP0456	456.0 KM	3952.00	STRP0631	631.0 KM	5210.00
STRP0107	107.0 KM	1225.00	STRP0282	282.0 KM	2620.00	STRP0457	457.0 KM	3960.00	STRP0632	632.0 KM	5218.00
STRP0108	108.0 KM	1232.00	STRP0283	283.0 KM	2628.00	STRP0458	458.0 KM	3967.00	STRP0633	633.0 KM	5225.00
STRP0109	109.0 KM	1238.00	STRP0284	284.0 KM	2636.00	STRP0459	459.0 KM	3974.00	STRP0634	634.0 KM	5232.00
STRP0110	110.0 KM	1244.00	STRP0285	285.0 KM	2644.00	STRP0460	460.0 KM	3981.00	STRP0635	635.0 KM	5239.00
STRP0111	111.0 KM	1251.00	STRP0286	286.0 KM	2652.00	STRP0461	461.0 KM	3989.00	STRP0636	636.0 KM	5246.00
STRP0112	112.0 KM	1257.00	STRP0287	287.0 KM	2660.00	STRP0462	462.0 KM	3996.00	STRP0637	637.0 KM	5253.00
STRP0113	113.0 KM	1264.00	STRP0288	288.0 KM	2668.00	STRP0463	463.0 KM	4003.00	STRP0638	638.0 KM	5261.00
STRP0114	114.0 KM	1270.00	STRP0289	289.0 KM	2676.00	STRP0464	464.0 KM	4010.00	STRP0639	639.0 KM	5268.00
STRP0115	115.0 KM	1277.00	STRP0290	290.0 KM	2685.00	STRP0465	465.0 KM	4018.00	STRP0640	640.0 KM	5275.00
STRP0116	116.0 KM	1283.00	STRP0291	291.0 KM	2693.00	STRP0466	466.0 KM	4025.00	STRP0641	641.0 KM	5282.00
STRP0117	117.0 KM	1289.00	STRP0292	292.0 KM	2701.00	STRP0467	467.0 KM	4032.00	STRP0642	642.0 KM	5289.00
STRP0118	118.0 KM	1296.00	STRP0293	293.0 KM	2709.00	STRP0468	468.0 KM	4039.00	STRP0643	643.0 KM	5296.00
STRP0119	119.0 KM	1302.00	STRP0294	294.0 KM	2717.00	STRP0469	469.0 KM	4047.00	STRP0644	644.0 KM	5304.00
STRP0120	120.0 KM	1309.00	STRP0295	295.0 KM	2725.00	STRP0470	470.0 KM	4054.00	STRP0645	645.0 KM	5311.00
STRP0121	121.0 KM	1315.00	STRP0296	296.0 KM	2733.00	STRP0471	471.0 KM	4061.00	STRP0646	646.0 KM	5318.00
STRP0122	122.0 KM	1321.00	STRP0297	297.0 KM	2741.00	STRP0472	472.0 KM	4069.00	STRP0647	647.0 KM	5325.00
STRP0123	123.0 KM	1328.00	STRP0298	298.0 KM	2749.00	STRP0473	473.0 KM	4076.00	STRP0648	648.0 KM	5332.00
STRP0124	124.0 KM	1334.00	STRP0299	299.0 KM	2757.00	STRP0474	474.0 KM	4083.00	STRP0649	649.0 KM	5339.00
STRP0125	125.0 KM	1341.00	STRP0300	300.0 KM	2765.00	STRP0475	475.0 KM	4090.00	STRP0650	650.0 KM	5347.00
STRP0126	126.0 KM	1347.00	STRP0301	301.0 KM	2772.00	STRP0476	476.0 KM	4098.00	STRP0651	651.0 KM	5354.00
STRP0127	127.0 KM	1353.00	STRP0302	302.0 KM	2780.00	STRP0477	477.0 KM	4105.00	STRP0652	652.0 KM	5361.00
STRP0128	128.0 KM	1360.00	STRP0303	303.0 KM	2788.00	STRP0478	478.0 KM	4112.00	STRP0653	653.0 KM	5368.00
STRP0129	129.0 KM	1366.00	STRP0304	304.0 KM	2796.00	STRP0479	479.0 KM	4119.00	STRP0654	654.0 KM	5375.00
STRP0130	130.0 KM	1373.00	STRP0305	305.0 KM	2804.00	STRP0480	480.0 KM	4127.00	STRP0655	655.0 KM	5382.00

SAP Service code	Lead in KM	Rate/MT	SAP Service code	Lead in KM	Rate/MT	SAP Service code	Lead in KM	Rate/MT	SAP Service code	Lead in KM	Rate/MT
STRP0131	131.0 KM	1379.00	STRP0306	306.0 KM	2812.00	STRP0481	481.0 KM	4134.00	STRP0656	656.0 KM	5390.00
STRP0132	132.0 KM	1386.00	STRP0307	307.0 KM	2819.00	STRP0482	482.0 KM	4141.00	STRP0657	657.0 KM	5397.00
STRP0133	133.0 KM	1392.00	STRP0308	308.0 KM	2827.00	STRP0483	483.0 KM	4149.00	STRP0658	658.0 KM	5404.00
STRP0134	134.0 KM	1398.00	STRP0309	309.0 KM	2835.00	STRP0484	484.0 KM	4156.00	STRP0659	659.0 KM	5411.00
STRP0135	135.0 KM	1405.00	STRP0310	310.0 KM	2843.00	STRP0485	485.0 KM	4163.00	STRP0660	660.0 KM	5418.00
STRP0136	136.0 KM	1411.00	STRP0311	311.0 KM	2851.00	STRP0486	486.0 KM	4170.00	STRP0661	661.0 KM	5425.00
STRP0137	137.0 KM	1418.00	STRP0312	312.0 KM	2858.00	STRP0487	487.0 KM	4178.00	STRP0662	662.0 KM	5433.00
STRP0138	138.0 KM	1424.00	STRP0313	313.0 KM	2866.00	STRP0488	488.0 KM	4185.00	STRP0663	663.0 KM	5440.00
STRP0139	139.0 KM	1430.00	STRP0314	314.0 KM	2874.00	STRP0489	489.0 KM	4192.00	STRP0664	664.0 KM	5447.00
STRP0140	140.0 KM	1437.00	STRP0315	315.0 KM	2882.00	STRP0490	490.0 KM	4199.00	STRP0665	665.0 KM	5454.00
STRP0141	141.0 KM	1443.00	STRP0316	316.0 KM	2890.00	STRP0491	491.0 KM	4207.00	STRP0666	666.0 KM	5461.00
STRP0142	142.0 KM	1450.00	STRP0317	317.0 KM	2897.00	STRP0492	492.0 KM	4214.00	STRP0667	667.0 KM	5468.00
STRP0143	143.0 KM	1456.00	STRP0318	318.0 KM	2905.00	STRP0493	493.0 KM	4221.00	STRP0668	668.0 KM	5476.00
STRP0144	144.0 KM	1463.00	STRP0319	319.0 KM	2913.00	STRP0494	494.0 KM	4229.00	STRP0669	669.0 KM	5483.00
STRP0145	145.0 KM	1469.00	STRP0320	320.0 KM	2921.00	STRP0495	495.0 KM	4236.00	STRP0670	670.0 KM	5490.00
STRP0146	146.0 KM	1475.00	STRP0321	321.0 KM	2929.00	STRP0496	496.0 KM	4243.00	STRP0671	671.0 KM	5497.00
STRP0147	147.0 KM	1482.00	STRP0322	322.0 KM	2936.00	STRP0497	497.0 KM	4250.00	STRP0672	672.0 KM	5504.00
STRP0148	148.0 KM	1488.00	STRP0323	323.0 KM	2944.00	STRP0498	498.0 KM	4258.00	STRP0673	673.0 KM	5511.00
STRP0149	149.0 KM	1495.00	STRP0324	324.0 KM	2952.00	STRP0499	499.0 KM	4265.00	STRP0674	674.0 KM	5518.00
STRP0150	150.0 KM	1501.00	STRP0325	325.0 KM	2960.00	STRP0500	500.0 KM	4272.00	STRP0675	675.0 KM	5526.00
STRP0151	151.0 KM	1507.00	STRP0326	326.0 KM	2968.00	STRP0501	501.0 KM	4279.00	STRP0676	676.0 KM	5533.00
STRP0152	152.0 KM	1514.00	STRP0327	327.0 KM	2975.00	STRP0502	502.0 KM	4286.00	STRP0677	677.0 KM	5540.00
STRP0153	153.0 KM	1520.00	STRP0328	328.0 KM	2983.00	STRP0503	503.0 KM	4294.00	STRP0678	678.0 KM	5547.00
STRP0154	154.0 KM	1527.00	STRP0329	329.0 KM	2991.00	STRP0504	504.0 KM	4301.00	STRP0679	679.0 KM	5554.00
STRP0155	155.0 KM	1533.00	STRP0330	330.0 KM	2999.00	STRP0505	505.0 KM	4308.00	STRP0680	680.0 KM	5561.00
STRP0156	156.0 KM	1540.00	STRP0331	331.0 KM	3007.00	STRP0506	506.0 KM	4315.00	STRP0681	681.0 KM	5569.00
STRP0157	157.0 KM	1546.00	STRP0332	332.0 KM	3014.00	STRP0507	507.0 KM	4322.00	STRP0682	682.0 KM	5576.00
STRP0158	158.0 KM	1552.00	STRP0333	333.0 KM	3022.00	STRP0508	508.0 KM	4329.00	STRP0683	683.0 KM	5583.00
STRP0159	159.0 KM	1559.00	STRP0334	334.0 KM	3030.00	STRP0509	509.0 KM	4337.00	STRP0684	684.0 KM	5590.00
STRP0160	160.0 KM	1565.00	STRP0335	335.0 KM	3038.00	STRP0510	510.0 KM	4344.00	STRP0685	685.0 KM	5597.00
STRP0161	161.0 KM	1572.00	STRP0336	336.0 KM	3046.00	STRP0511	511.0 KM	4351.00	STRP0686	686.0 KM	5604.00
STRP0162	162.0 KM	1578.00	STRP0337	337.0 KM	3053.00	STRP0512	512.0 KM	4358.00	STRP0687	687.0 KM	5612.00
STRP0163	163.0 KM	1584.00	STRP0338	338.0 KM	3061.00	STRP0513	513.0 KM	4365.00	STRP0688	688.0 KM	5619.00

SAP Service code	Lead in KM	Rate/MT	SAP Service code	Lead in KM	Rate/MT	SAP Service code	Lead in KM	Rate/MT	SAP Service code	Lead in KM	Rate/MT
STRP0164	164.0 KM	1591.00	STRP0339	339.0 KM	3069.00	STRP0514	514.0 KM	4372.00	STRP0689	689.0 KM	5626.00
STRP0165	165.0 KM	1597.00	STRP0340	340.0 KM	3077.00	STRP0515	515.0 KM	4380.00	STRP0690	690.0 KM	5633.00
STRP0166	166.0 KM	1604.00	STRP0341	341.0 KM	3085.00	STRP0516	516.0 KM	4387.00	STRP0691	691.0 KM	5640.00
STRP0167	167.0 KM	1610.00	STRP0342	342.0 KM	3092.00	STRP0517	517.0 KM	4394.00	STRP0692	692.0 KM	5647.00
STRP0168	168.0 KM	1616.00	STRP0343	343.0 KM	3100.00	STRP0518	518.0 KM	4401.00	STRP0693	693.0 KM	5655.00
STRP0169	169.0 KM	1623.00	STRP0344	344.0 KM	3108.00	STRP0519	519.0 KM	4408.00	STRP0694	694.0 KM	5662.00
STRP0170	170.0 KM	1629.00	STRP0345	345.0 KM	3116.00	STRP0520	520.0 KM	4415.00	STRP0695	695.0 KM	5669.00
STRP0171	171.0 KM	1636.00	STRP0346	346.0 KM	3124.00	STRP0521	521.0 KM	4423.00	STRP0696	696.0 KM	5676.00
STRP0172	172.0 KM	1642.00	STRP0347	347.0 KM	3132.00	STRP0522	522.0 KM	4430.00	STRP0697	697.0 KM	5683.00
STRP0173	173.0 KM	1649.00	STRP0348	348.0 KM	3139.00	STRP0523	523.0 KM	4437.00	STRP0698	698.0 KM	5690.00
STRP0174	174.0 KM	1655.00	STRP0349	349.0 KM	3147.00	STRP0524	524.0 KM	4444.00	STRP0699	699.0 KM	5698.00
STRP0175	175.0 KM	1661.00	STRP0350	350.0 KM	3155.00	STRP0525	525.0 KM	4451.00	STRP0700	700.0 KM	5705.00

Security fencing with Gate & locking arrangement and one side removable fencing, three sides fixed fencing to DTRs.

PLAN

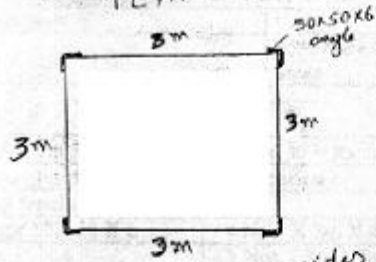

ISOMETRIC VIEW

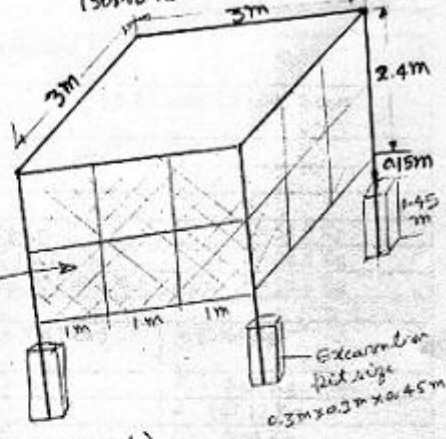

All four sides GI chain link mesh of 8 gauge of size 50.8mm x 50.8mm (2" x 2") to be weld fixed

Elevation of detachable fencing (one side)

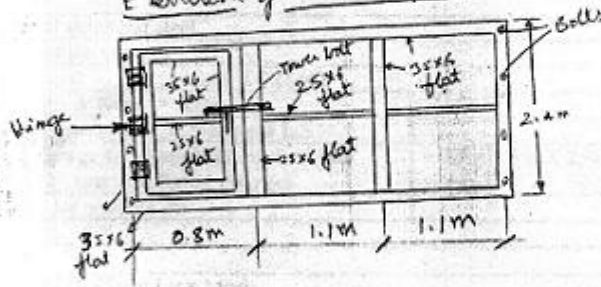

Elevation of fixed fencing (Three sides)

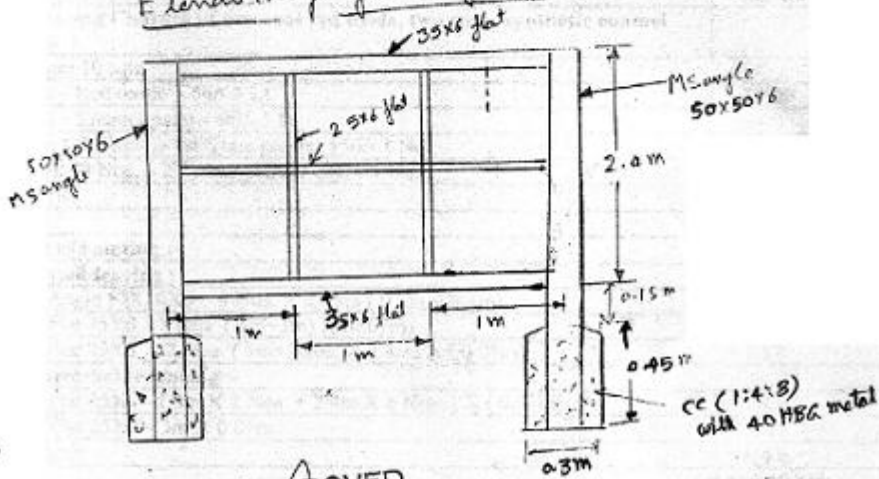

APPROVED

CHIEF GENERAL MANAGER  
OPERATIONS & MAINTENANCE  
ASSISTANT TIRUPATI

P. Jagannath  
A01/c